



**Speedster**

# Parts list Speedster

## CONTENT

<b>Ordering information .....</b>	<b>2</b>
<b>Parts order example.....</b>	<b>3</b>
<b>Coffee boiler .....</b>	<b>4</b>
Model 2008-2011 (slim group-neck): Left (element) side.....	4
Model 2008-2011 (slim group-neck): Right (fill) side.....	5
Model 2008-2011 (slim group-neck): Group valve .....	6
Model 2008-2011 (slim group-neck): Group .....	7
Model 2011-... (wide group neck): parts within body .....	8
Model 2011-... (wide group neck): parts outside body.....	9
Group valve bases: evolution.....	10
<b>Heating elements steam and coffee: evolution .....</b>	<b>11</b>
<b>Steam boiler.....</b>	<b>12</b>
Model 2008: Left (element) side .....	12
Model 2008: Right (heat exchanger) side .....	13
Steam boiler model 2009-...: left (element) side .....	14
Steam boiler model 2009-...: right (heat exchanger) side .....	15
<b>Electronic control.....</b>	<b>16</b>
<b>Waterways right hand side: manifold.....</b>	<b>17</b>
<b>Waterways right hand side: mix-block.....</b>	<b>18</b>
<b>Waterways right hand side, water-lines .....</b>	<b>19</b>
<b>Front-panel mounted items .....</b>	<b>20</b>
gauges, PPIC, hot water switch .....	20
Progressive pre-infusion cylinder.....	21
Shot timer – first model.....	22
Shot timer display, PCB, and mounting material.....	23
Steam valve and wand .....	24
Hot water valve and wand.....	25
Steam and hot water valve .....	26
Brew lever.....	27
<b>Discharge, model 2014 .....</b>	<b>28</b>
<b>Frame and panel-work .....</b>	<b>29</b>
Cup warming tray.....	30
Drip tray, steam boiler isolation.....	31
Front and bottom panel.....	32
Top panel.....	33
<b>Pump, portafilter, etc. ....</b>	<b>34</b>

Explanation for tables:

nip	not in picture
s.st.	stainless steel
#	first 3 digits of machine number
article code in red	part no longer used in present manufacturing. Original parts may still be available but can run out. Replacement parts are mostly available (see remark).

Order parts via: [spareparts@keesvanderwesten.com](mailto:spareparts@keesvanderwesten.com)

See “Ordering information” and “Parts order example” on pages 2 and 3.

**When ordering parts, if possible specify the machine number the part is meant for.  
Refer to this parts-list revision date when ordering.**



## Ordering information

When ordering spare parts directly from Kees van der Westen we ask you to send your parts list to [spareparts@keesvanderwesten.com](mailto:spareparts@keesvanderwesten.com) as comprehensive as possible to minimise the chance of mistakes in the delivered parts. Include the machine model, type and machine number if the parts order concerns a specific machine, also include the parts-list version you consulted.

The list should state amount, parts number and short description, see the example on the next page.

You can download the different parts lists:

Spirit: <http://www.keesvanderwesten.com/assets/spirit-parts-list.pdf>

Mirage: <http://www.keesvanderwesten.com/assets/mirage-parts-list.pdf>

Speedster: <http://www.keesvanderwesten.com/assets/speedster-parts-list.pdf>

If the parts list is not conclusive, seek contact with [support@keesvanderwesten.com](mailto:support@keesvanderwesten.com) before ordering.

## One recipient please

When ordering parts or putting forward a question about parts, please address only one recipient on our side. When more employees receive the same email/request it is possible that all or none of the recipients feel responsible to take action.

## Receive parts

In order to receive your spare parts order we need your full details, see example below:

- Billing address
- Delivery address
- Contact person
- Telephone number(s)
- E-mail address

As we do not know the final UPS shipping costs upon sending your order, we will bill you after these costs are known to us.

So you will receive the goods first and the invoice afterwards.

## Payment

As for the payment of your order. Payment can be settled with PayPal or a bank wire transfer. We do not accept direct credit card transactions.

If you have a PayPal account set up it should be settled rather quickly. We could send you a payment request which takes care of it almost instantly.

A bank wire transfer is also possible, but we do not know if your bank charges additional costs and/or fees.

Please let us know which option you prefer. If you would like to pay with PayPal, we kindly ask you to inform us which email address we may send our request.



## Parts order example

Send your list to: [spareparts@keesvanderwesten.com](mailto:spareparts@keesvanderwesten.com)

Machine model	Speedster	parts order
Machine type		
Machine number	1230217	
Parts list	March 21, 2017	

[illegible]

Customer number	..... (if known)
Contact person	Coffee Lover
Billing address	Espressostreet 30 1234 Arabica COLUMBIA
Delivery address	Ristrettolane 15-ML 1234 Arabica COLUMBIA
Telephone	+12 345 678 9012
e-mail	<a href="mailto:c.lover@gmail.com">c.lover@gmail.com</a>

**Remark:** When ordering numerous parts for older machines it is wise to explain here what you like to establish. It helps us to identify possible mistakes in the parts-order such that we will seek contact to clarify the order before picking and shipping.



## Coffee boiler

Model 2008-2011 (slim group-neck): Left (element) side

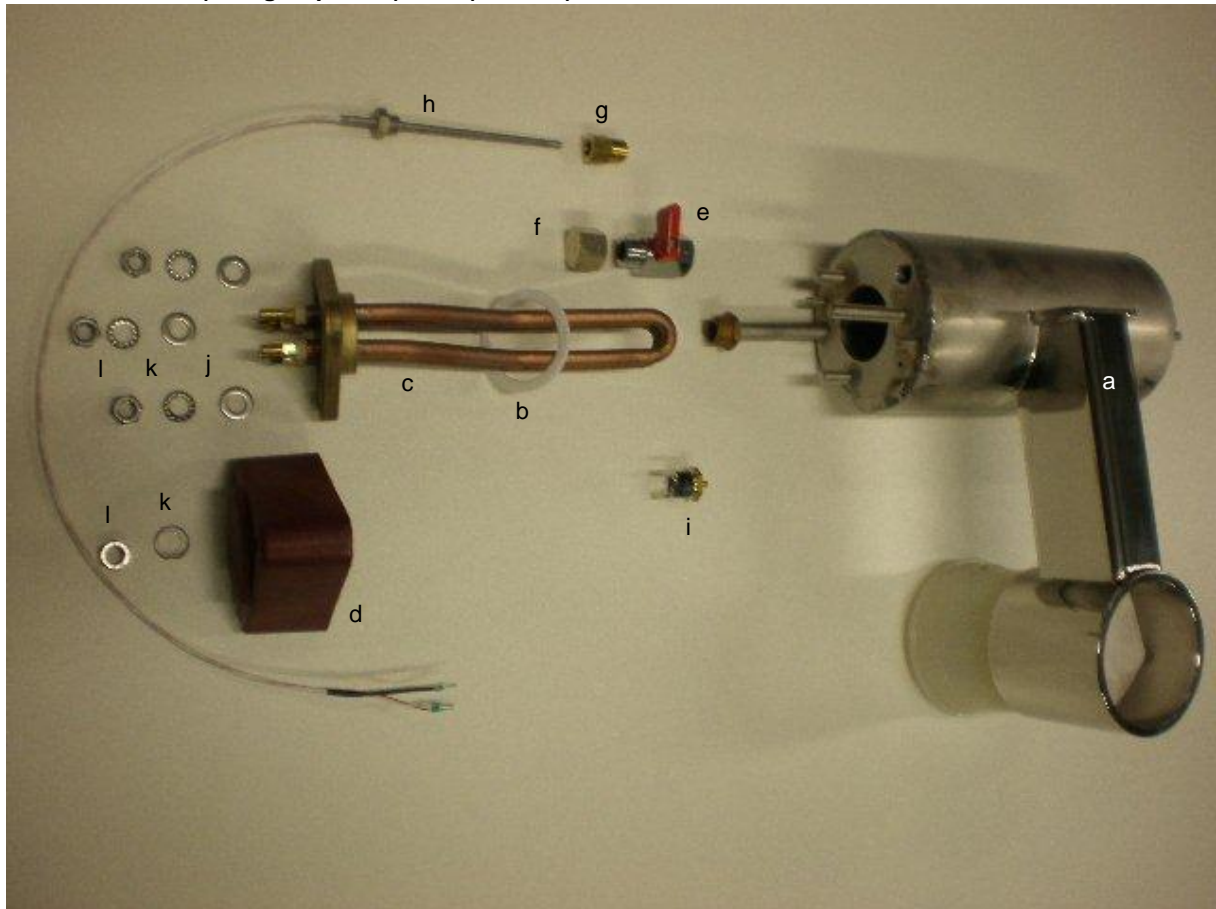

	part number	short description	remark
a	<del>G1001</del>	coffee boiler with slim group-neck; s.st.	#000-029
	<del>G1001-v2</del>	coffee boiler with slim group-neck and boiler supports; s.st.	#030-147
b	B002	ring 52x40x2; Teflon, as gasket between element and boiler	
c		heating element 900W; screw connections	see page 11
d	<del>E1016</del>	heating element cover Speedster; brown plastic, machined	
e	B076-I	ball valve 3/8F-3/8M; nickel plated brass, lever handle	
f	B077	plug 3/8F; nickel plated brass	
g	B1067	fitting 1/8F-1/4M; brass	
h	<del>E1004*</del>	temperature sensor Pt-100 1/8M; 3-wire, 100mm (JUMO)	see E1004-T**
nip	E1004-T	temperature sensor Pt-100 1/8M; 2-wire, 100mm (Tasseron)	
i	E1018-V	overheat safety switch 107°C M4; automatic re-set	
j	C-RS-M8	washer din125A M8; s.st.	
k	C-RT-M8	lock washer din6798A M8; s.st.	
l	C-MH-M8	nut din934 M8; s.st.	

\* VS-E1004 corresponds to sensor with appr. 10 cm long cable

\*\* E1004-T is a 2-wire sensor, JUMO controllers can be set to function with this sensor type. Make sure to order the sensor-cable as well and instructions to adjust the JUMO controller.





**Model 2008-2011 (slim group-neck): Right (fill) side**



	part number	short description	remark
a		coffee boiler with slim group-neck; s.st.	see page 4
b	B1045	2mm copper tube; coffee boiler ↔ PPIC (Speedster), pressure gauge (Spirit)	shape deviates, bends easily
c	B1039	fitting 1/8M-1/8M; brass	
d	B082	ring 1/8"; copper	
e	B1046-v1	8mm copper tube with knee fitting 1/4M-1/4M (injection tube coffee boiler)	



# Model 2008-2011 (slim group-neck): Group valve

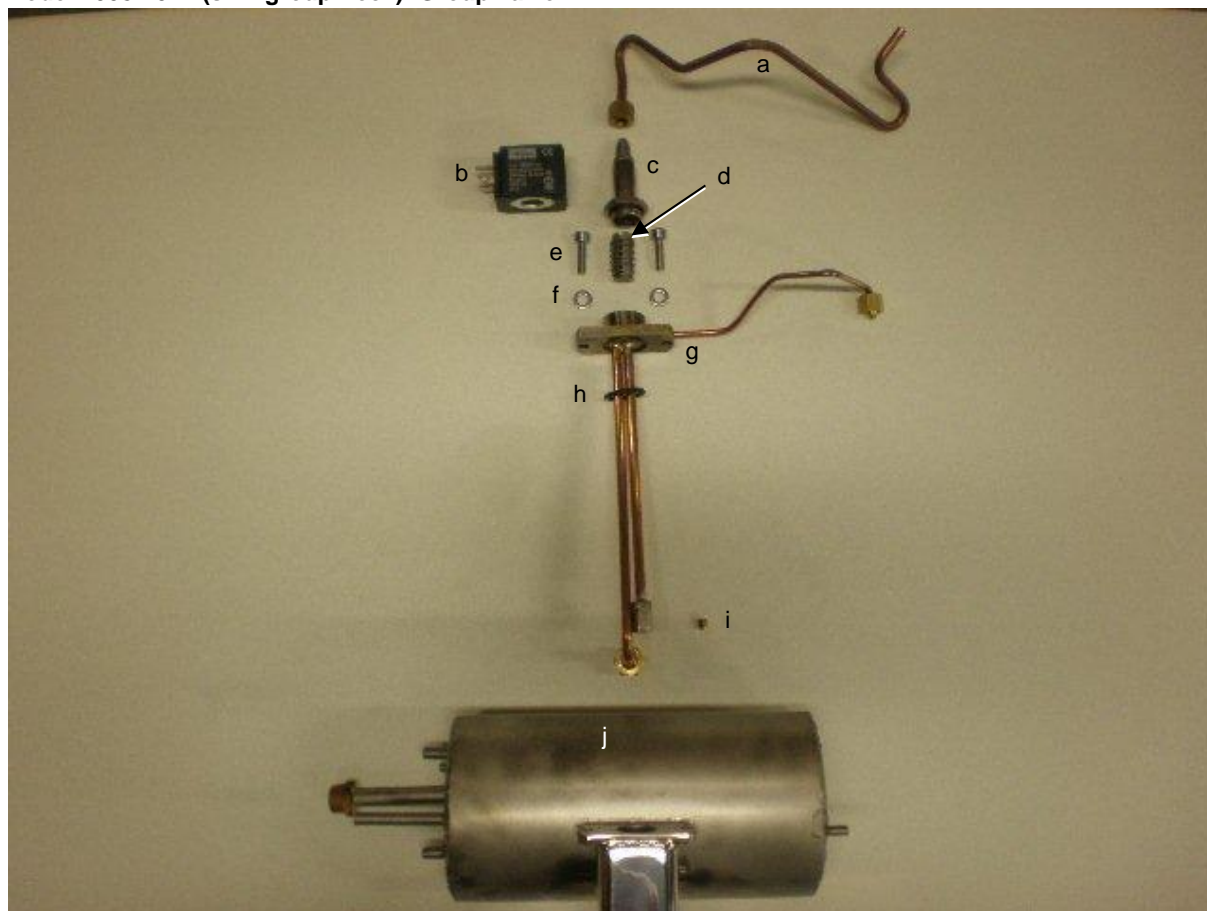

	part number	short description	remark
a	B1042	6mm copper tube; group valve ↔ discharge	
b	E027-S2	coil 230Vac (for E028-K & E1023-P & E1024 Parker)	
	E027-SJ	coil 200Vac (for E028-K & E1023-P & E1024 Parker)	a.o. Japan
	E1027-S1	coil 115Vac (for E028-K & E1023-P & E1024 Parker)	a.o. USA
c	E1023-P	3-way valve, without base (old Speedster group-valve; Parker)	#000-147
d			
e	C-BZ-M6x20	Allen bolt din912 M6x20; s.st.	
f	C-RS-M6	washer din125A M6; s.st.	
g		group valve base with copper tubing	see "group valve bases", page 10
h	P016	O-ring 20.3x2.62mm; Viton (PPIC Mir, group valve Spe)	
i	replaced	jet, 0.6mm; brass (later relocated to S-B050)	see B034-06
nip	B034-06	jet M6x6 orifice 0.6mm; s.st.	
j		coffee boiler with slim group-neck; s.st.	see page 4



# Model 2008-2011 (slim group-neck): Group

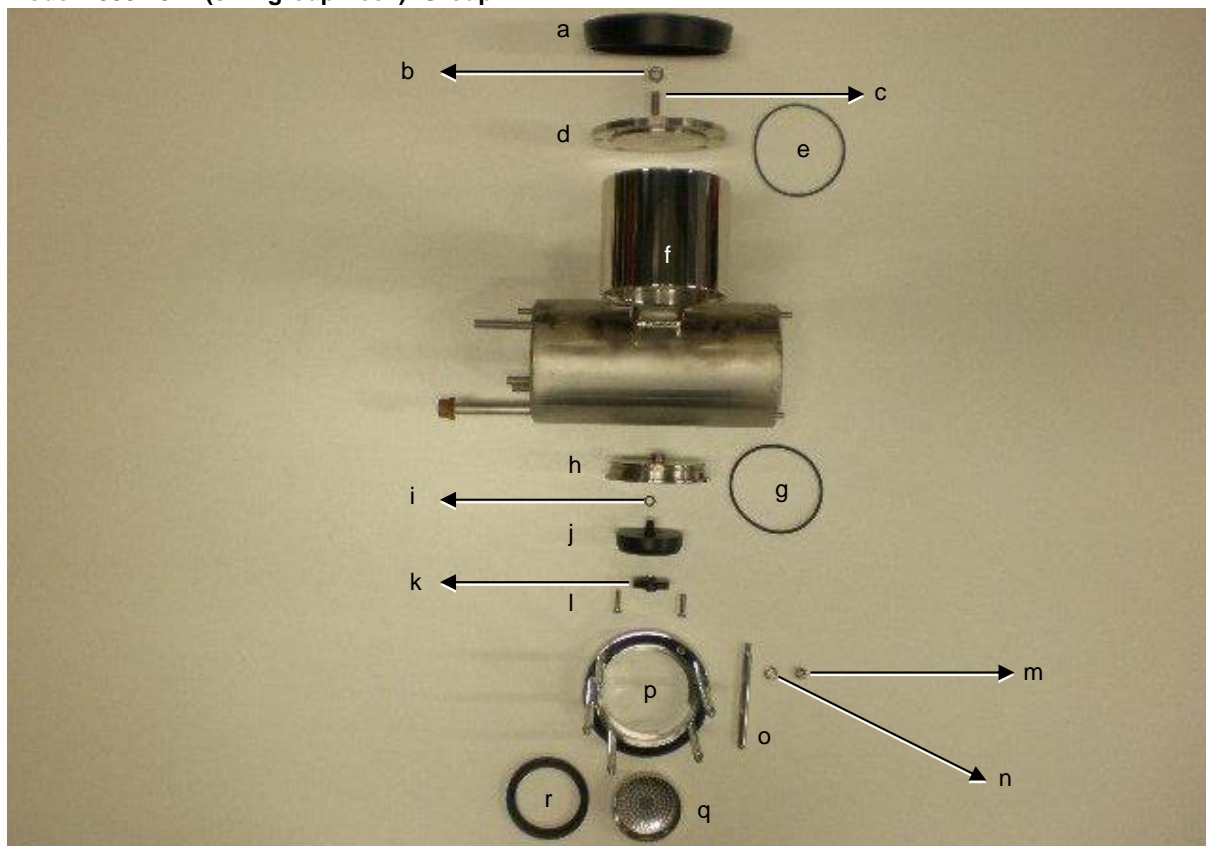

	part number	short description	remark
a	replaced	group protective cap; black POM	see G1010-B
nip	G1010-B	group protective cap; black Bakelite	
b	C-MH-M8	nut din934 M8; s.st.	old model cover
c	C-SS-M8x16	set screw din916 M8x16; s.st.	
d	replaced	group cover; s.st.	see G1002-v2, page 9
e	G1004-C	O-ring 75x2.5mm; Viton, top of group, standard size	
f		coffee boiler with slim group-neck; s.st.	see page 4
g	G1004-G	O-ring 74x3.5mm; Viton, bottom of group, standard size	
h	G1003	group base; s.st. (version 1, compression seal)	#000-227
i	replaced	O-ring 5.7x1.9mm; Viton	as set replaced by G1009-Cv3, see page 9
j+k		dispersion base and plate; POM (replaced by PEEK)	
l		machine screw din964 M5x12; s.st.	
m	C-MH-M6	nut din934 M6; s.st.	
n	C-RS-M6	washer din125A M6; s.st.	
o	<del>G1005</del>	group head rod; s.st.	G1005-v2, see p. 9
p	<del>G1006</del>	group bayonet; chromed brass (without rods)	G1006-v2, see p. 9
q	G013	group shower screen; s.st., KvdW logo	
r	G014-80A	group ring; 8.0mm (Arinca)	if bayonet wears out, use thicker group-ring
	G014-85A	group ring; 8.5mm (Arinca)	
	G014-90A	group ring; 9.0mm (Arinca)	



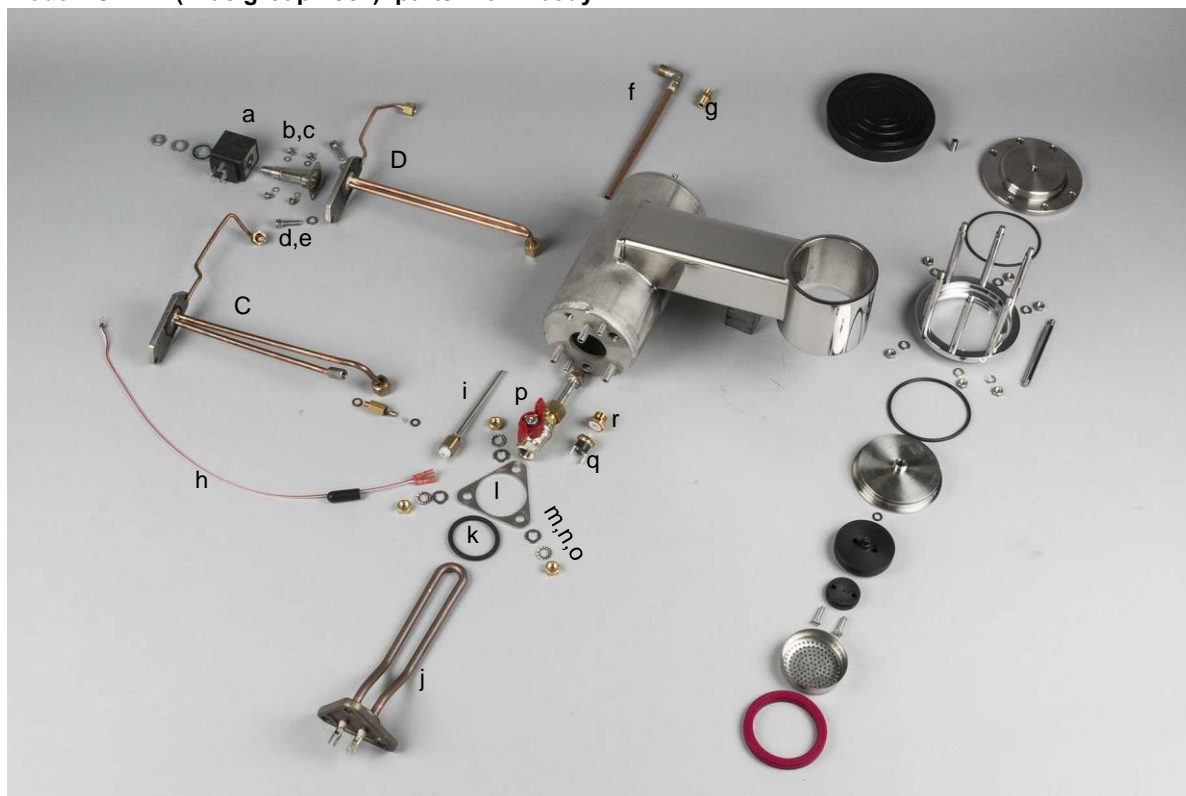

**Model 2011-... (wide group neck): parts within body**

	part number	short description	remark
C,D		group valve mounting plate with tubing	see page 10
a	E1023-230	3-way flange valve, orifice 1.5mm; s.st., coil 230Vac (Parker)	
	E1023-110	3-way flange valve, orifice 1.5mm; s.st., coil 115Vac (Parker)	
	E1023-200	3-way flange valve, orifice 1.5mm; s.st., coil 200Vac (Parker)	
b	C-SK-M4x06	Phillips screw din7985 M4x6; s.st.	
c	C-RT-M4	lock washer din6798A M4; s.st.	
d	C-BZ-M6x20	Allen bolt din912 M6x20; s.st.	
e	C-RS-M6	washer din125A M6; s.st.	
f	B1046-v1	8mm copper tube with knee fitting 1/4M-1/4M (injection tube coffee boiler)	
g	B1039	fitting 1/8M-1/8M; brass	
h	E1005-KS	temperature sensor cable 450mm with fastons	
	C-HK-G	heat resistant cap, 9.5x25.4mm (with punctured hole)	
i	E1004-T	temperature sensor Pt-100 1/8M; 2-wire, 100mm (Tasseron)	
j		heating element 900W	see page 11
k	B1010-v2	O-ring 39x4.5mm; Viton (gasket for heating element)	
l	E1070	triangular O-ring spacer for s.st. boiler 3mm thick; s.st.	
m	C-RS-M8	washer din125A M8; s.st.	
n	C-RT-M8	lock washer din 6798A M8; s.st.	
o	G1017	nut M8, 5mm thick; brass	
p	B076	ball valve 1/4F-1/4F; nickel plated brass, butterfly handle	
	S037	fitting 1/4M-3/8M; brass	
	B1057-v1	8mm s.st. tube 3/8M-3/8F (Speedster drain)	
q	E1018-V	overheat safety switch 107°C M4; automatic re-set	
r	G1018	plug 1/4M-M4F; brass	

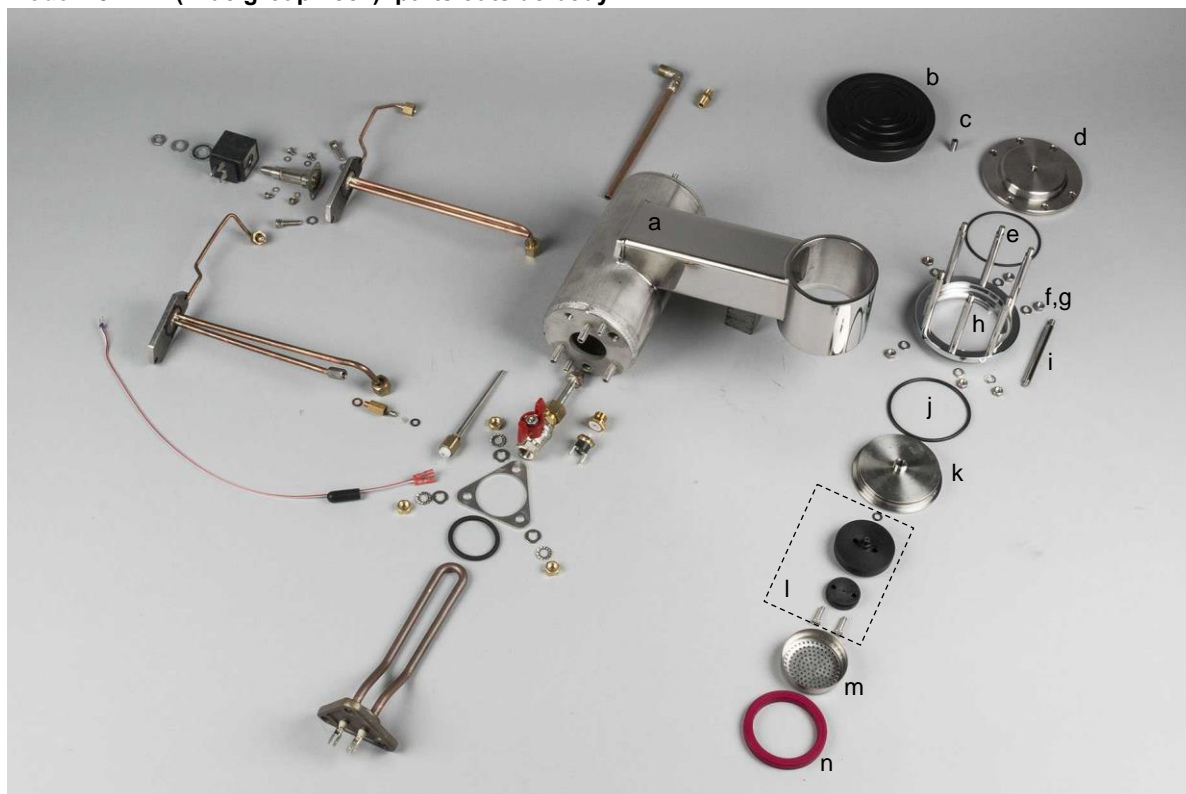

**Model 2011-... (wide group neck): parts outside body**

	part number	short description	remark
nip	<del>G001-2</del>	coffee boiler; wide short neck, s.st.	# 148-189
a	G1001-Bv3	coffee boiler; wide long neck, s.st.	# 190-...
nip	<del>G1010</del>	group protective cap; black POM	see G1010-B
b	G1010-B	group protective cap; black Bakelite	no fit on G1002
c	C-SS-M8x16	set screw din916 M8x16; s.st.	
nip	<del>G1002</del>	group cover, flat top; s.st.	see G1002-v2
d	G1002-v2	group cover, bulged top; s.st.	
e	G1004-C	O-ring 75x2.5mm; Viton, top of group, standard size	other sizes available
f	C-MH-M6	nut din934 M6; s.st.	
g	C-RS-M6	washer din125A M6; s.st.	
h	G1006-v2	group bayonet; chromed brass (without rods)	
i	G1005-v2	group head rod; s.st. (with tool-grip)	
j	G1004-G	O-ring 74x3.5mm; Viton, bottom of group, standard size	other sizes available
k	G1003-v2	group base; threads seal version, s.st.	
	G1003-v3	group base; O-ring seal version, s.st.	for Idro-matic
l	out of stock	O-ring 5.7x1.9mm; Viton	replaced by beige PEEK material: G1009-Cv3
		dispersion base and plate; black POM	
		machine screw din963 M5x20; s.st.	
nip	G1009-Cv3	dispersion set; beige PEEK (base, plate, O-ring, screws)	
m	G013	group shower screen; s.st., KvdW logo	
n	G014-80A	group ring; 8.0mm (Arinca)	if bayonet wears out, use thicker group-ring
	G014-85A	group ring; 8.5mm (Arinca)	
	G014-90A	group ring; 9.0mm (Arinca)	



## Group valve bases: evolution

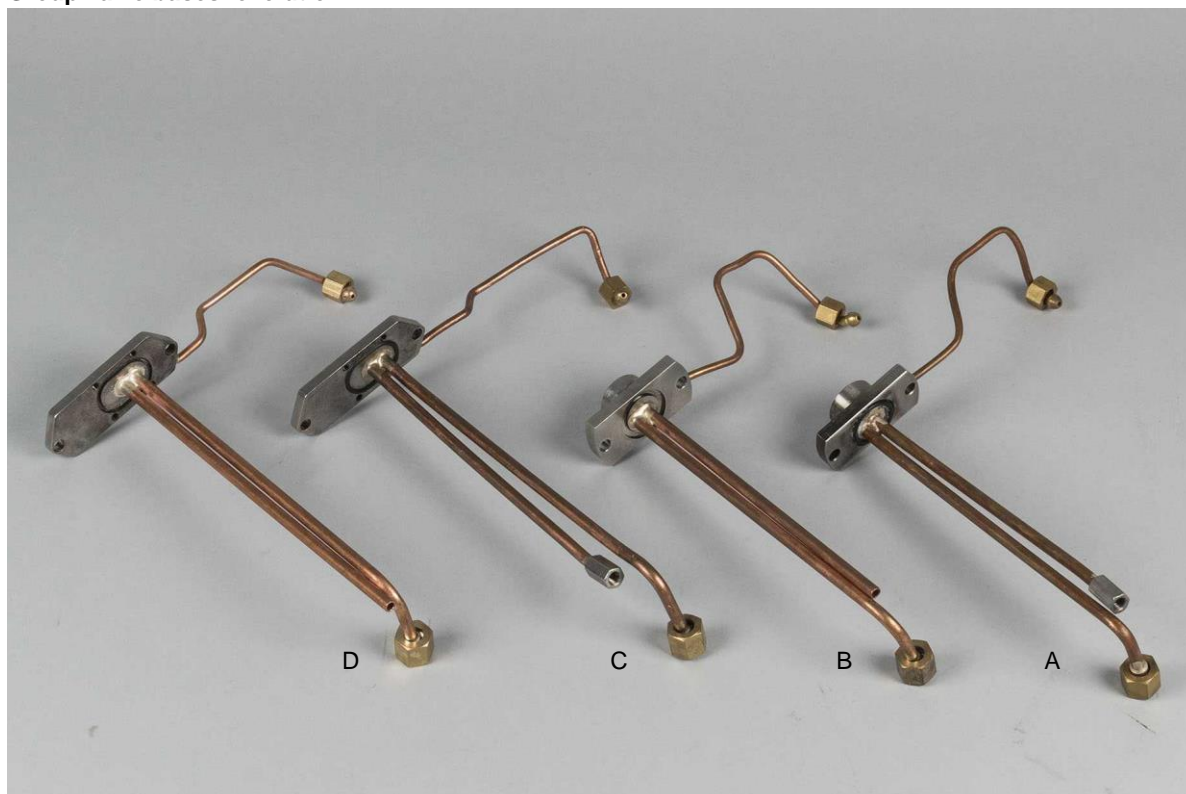

Used in 2014 is most left (D). Original in 2008 is most right (A).

In the early model Speedster, the group-valve mounting plate is narrow and a deconstructed 3-way solenoid valve is screwed directly onto the valve mounting plate (version A and B). An in-group jet (or restrictor) is incorporated in the upper tube inside the group (version A). The in-group jet can be re-located to another location in the machine (copper tubes S-B1050-A + S-B1050-B) making the in-group jet-mount obsolete (version B). Version B is only used as an after sales modification of older machines.

The wide-neck coffee boiler makes use of a complete 3-way solenoid flange valve that mounts onto the base plate with 4 machine screws (versions C and D). Version C has been installed in very few new Speedsters.

	part number	short description	remark
A	<del>B1140</del>	group valve mounting plate with 3 tubes and in-group jet (compression seal)	# 001-029
B	<del>B1140-v1</del>	group valve mounting plate with 3 tubes (compression seal)	# 030-147
nip	P016	O-ring 20.3x2.62mm; Viton (PPIC Mir, group valve Spe)	# 000-147
C	- - -	cannot be ordered	
D	<del>G1140-v2</del>	group valve mounting plate with 3 tubes (wide short neck, compression seal)	# 148-190
	<del>G1140-v3</del>	group valve mounting plate with 3 tubes (wide long neck, compression seal)	# 191-629
nip	B1041-v1	O-ring 25x2.5mm; Viton (fits G1140-v2, G1140-v3, G6042-v2)	# 148-...
nip	G6042-v2	group valve mounting plate with short PPIC tube (compression seal)	# 630-... <a href="#">see below</a>
nip	G6050-06	flat-jet for group 0.6mm; s.st.	
	G6050-08	flat-jet for group 0.8mm; s.st.	
	G6050-10	flat-jet for group 1.0mm; s.st.	
nip	B6003-O	O-ring 6.07x1.78mm; Viton	for flat-jet

G6042-v2 replaces G1140-v3 from machine #630-...but is not a 1-on-1 replacement, more parts are needed to make it fit an older machine:

B1009 T-fitting 1/8M-1/M8-1/8M

B1062 4mm tubing group-line ↔ pre-infusion

To accommodate the Idro-matic, a new group-valve mounting plate with adapter is needed: SR-G6042-v3. This item fits only onto the new group bottom G1003-v3 and seals with O-rings.



## Heating elements steam and coffee: evolution

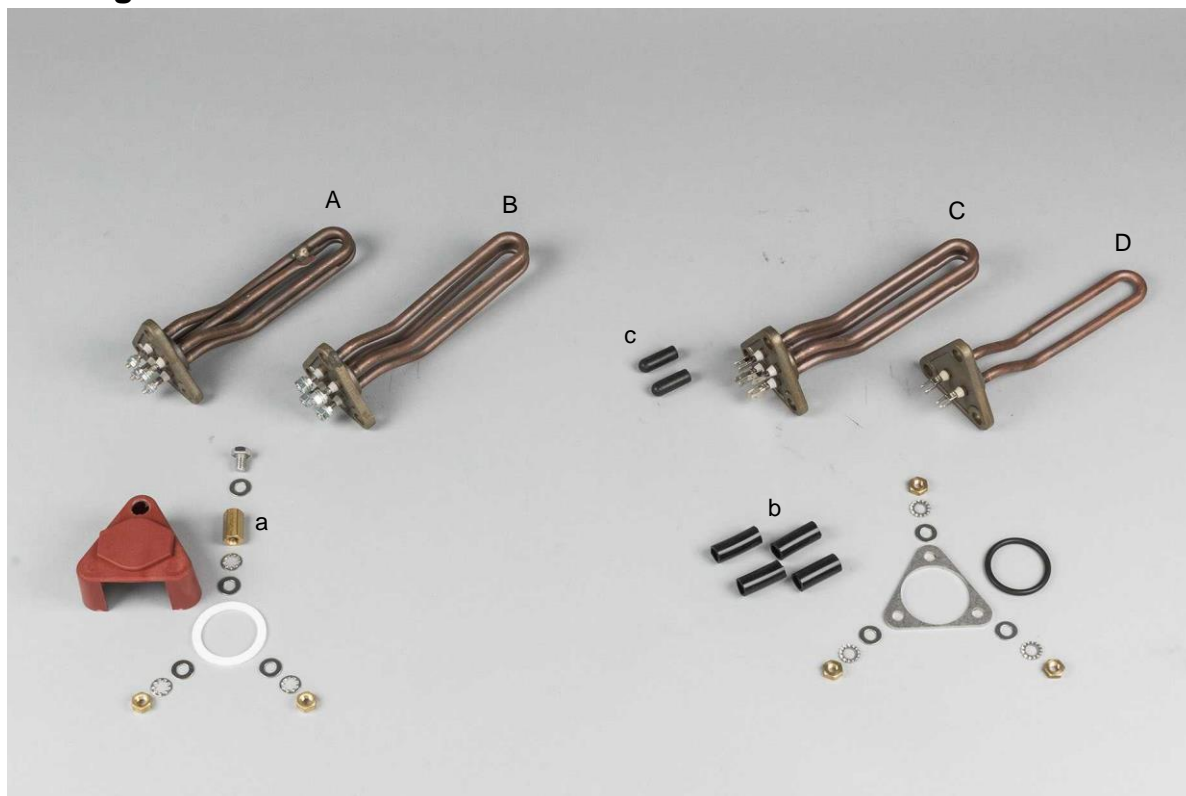

Different heating elements used over the years.

A&B: screw-on connectors, Teflon seal, plastic cover (also possible to seal with Viton O-ring and spacer).

C&D: faston connectors, Viton O-ring as seal, triangular spacer, silicone hose for electric isolation.

Machines were first made with screw-on connectors on the wire loom. This changed later to faston connectors. The screw-on connectors allow for an element cap to be mounted, the faston connectors do not. It may not be possible to install a faston element in an originally screw-on machine without major changes to the wire loom. The Teflon seal used earlier was a "one-use-only"; when the element was taken out, the seal had to be replaced. This changed later to the Viton O-ring. The s.s. spacer makes sure that the O-ring cannot be "squeezed out" when tightening the element to the boiler.

The steam boiler has a maximum capacity of 1800W, divided over 2 spirals of 900W each. This element is made in both 115Vac as 230Vac. The coffee boiler has a maximum heating capacity of 900W. This element is only made in a 230Vac version. In a 115Vac machine, the double-spiral steam boiler element is also mounted in the coffee boiler, but 1 spiral is not used.

	part number	short description	remark
A	<del>E1020-A</del>	heating element 2x900W; 230Vac, screw-on (Firem)	steam
B	<del>E1021-16S</del>	heating element 2x900W; 115Vac, screw-on (Iberital)	steam and coffee
C	<del>E1021</del>	heating element 2x900W; 230Vac, faston (Iberital)	steam
	<del>E1021-16</del>	heating element 2x900W; 115Vac, faston (Firem)	steam and coffee
D	E1020	heating element 1x900W; 230Vac, faston (Iberital)	coffee
nip	<del>E1020-v2</del> <del>E1022-16-V2</del> <del>E1021-v2</del> <del>E1021-16-V2</del>	heating element 1x900W; 230Vac, faston, (TRIAS) heating element 1x900W; 115Vac, faston, (TRIAS) heating element 2x900W; 230Vac, faston, (TRIAS) heating element 2x900W; 115Vac, faston, (TRIAS)	* see below
nip	E1020-v3 E1021-v3	heating element 1x900W; 230Vac, faston (Backer) heating element 2x900W; 230Vac, faston (Backer)	available not yet available
a	E1046	connection nut din6334 M8x30; brass	
b	C-HS-ZZ10x14	hose 10x14; black silicone, per meter	order length: 3.5cm
c	C-HK-G	heat resistant cap, 9.5x25.4mm (for unused faston connectors)	115Vac only

\* heating elements manufactured by Triatherm (marked TRIAS) have a built-in O-ring chamber and must be mounted with a 42x4.5 mm O-ring without the triangular spacer.





# Steam boiler

## Model 2008: Left (element) side

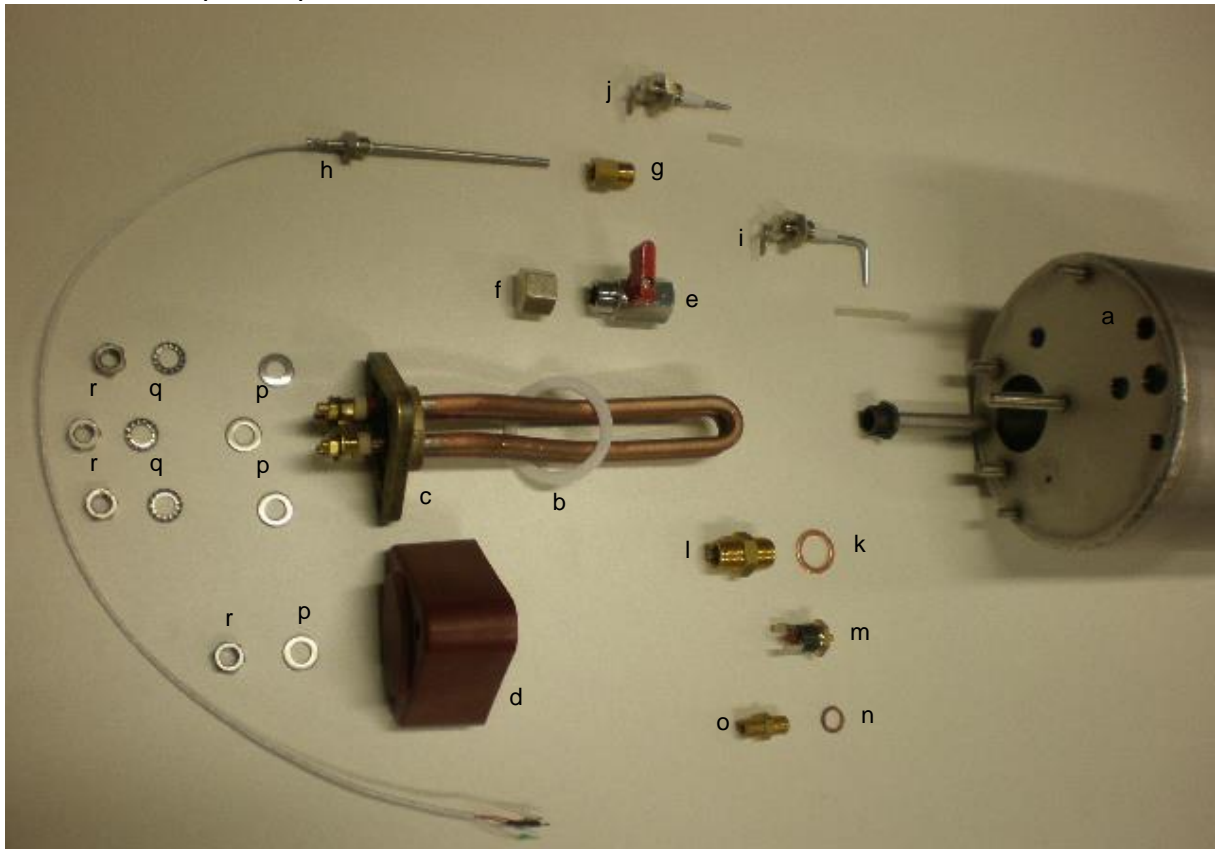

	part number	short description	remark
a	<del>B001-SX</del>	steam boiler, bare; s.st., (10/2008-04/2009)	# 000 - 029
	<del>B1001-Sv1</del>	steam boiler, bare; s.st., model 2009	# 030 - ...
b	B002	ring 52x40x2; Teflon, as gasket between element and boiler	
c		heating element 2x900W; ...Vac, screw-on	see page 11
d	<del>E1016</del>	heating element cover Speedster; brown plastic, machined	
e	B076-I	ball valve 3/8F-3/8M; nickel plated brass, lever handle	#... - 126
f	B077	plug 3/8F; nickel plated brass	
g	B1067	fitting 1/8F-1/4M; brass	
h	<del>E1005</del>	temperature sensor Pt100 1/8M; 3-wire, 27mm, s.st. (JUMO)	E1005-LV*
i	<del>E1006</del>	operational level probe 1/4M (LIV); s.st. bent, with sleeve	E1029, see p. 14
j	<del>E1007</del>	security level probe 1/4M (SIC); s.st.	E029-C, see p. 14
k	B079	ring 1/4"; copper	
l	S036	fitting 1/4M-1/4M; brass	
m	E1018-A	overheat safety switch 145°C M4; manual re-set	
n	B082	ring 1/8"; copper	
o	B1039	fitting 1/8M-1/8M; brass	
p	C-RS-M8	washer din125A M8; s.st.	
q	C-RT-M8	lock washer din6798A M8; s.st.	
r	C-MH-M8	nut din934 M8; s.st.	

\*picture shows wrong sensor. Replacement E1005-LV is 2-wire with separate cable. See also p. 14 item p.





# Model 2008: Right (heat exchanger) side

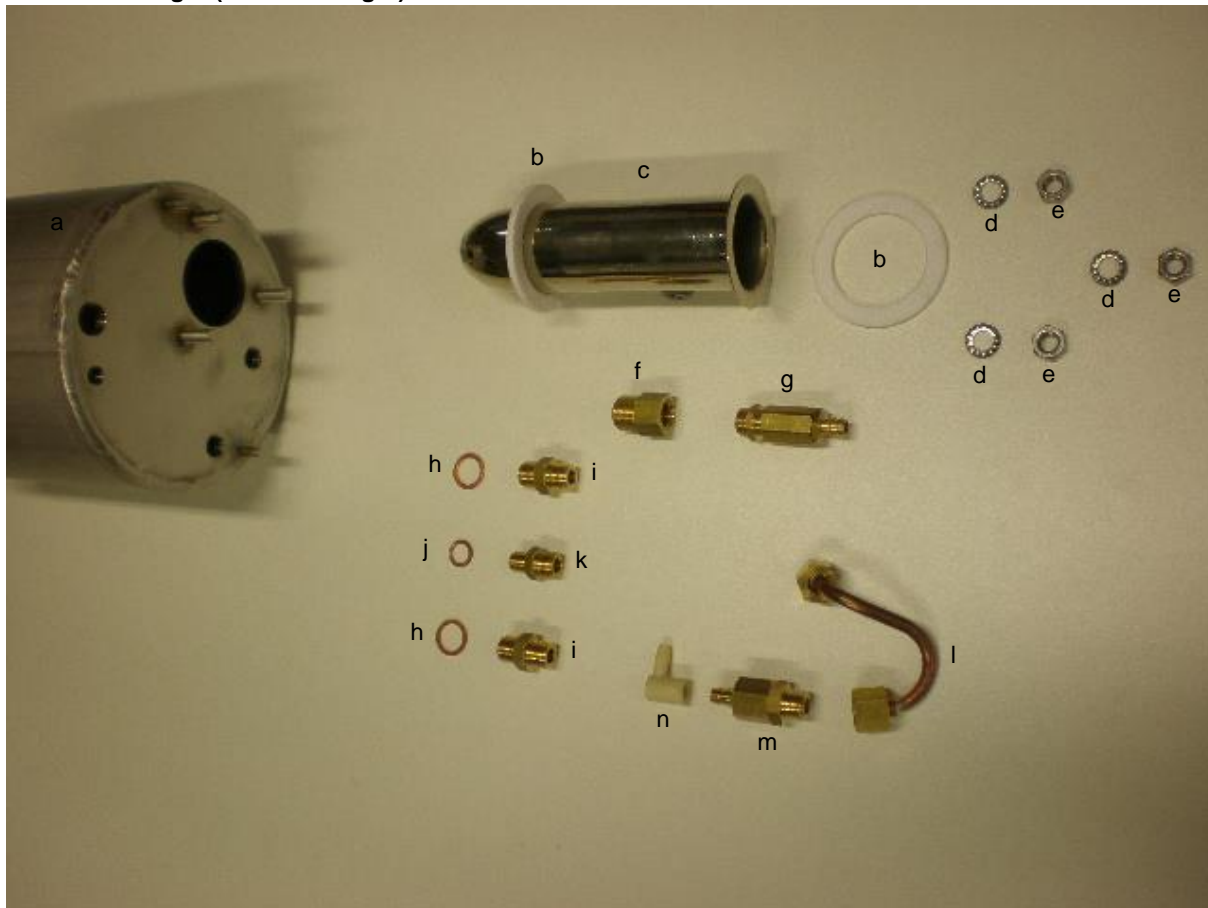

	part number	short description	remark
a	<del>B001-SX</del>	steam boiler, bare; s.st.	# 000 - 029
	<del>B1001-Sv1</del>	steam boiler, bare; s.st., model 2009	# 030 - ...
b	no longer available	gasket 59x42x3; Teflon (for heat exchanger)	see heat exchanger on page 15
c		heat exchanger; chrome plated brass. (# ... - 125)	
d	C-RT-M8	lock washer din6798A M8; s.st.	
e	C-MH-M8	nut din934 M8; s.st.	
f	B1069	fitting 1/4F-3/8M; brass	
g	B1032	pressure safety valve 1/4M-hose pillar; 3.0 bar, brass	
h	B079	ring 1/4"; copper	
i	S036	fitting 1/4M-1/4M; brass	
j	B082	ring 1/8"; copper	
k	S035	fitting 1/8M-1/4M; brass	
l	B1056	6mm copper tube; steam boiler ↔ anti-vacuum valve	
m	B033	anti-vacuum valve 1/4M-hose pillar; brass	
n	no longer available	knee-adapter; Teflon	obsolete



# Steam boiler model 2009-...: left (element) side

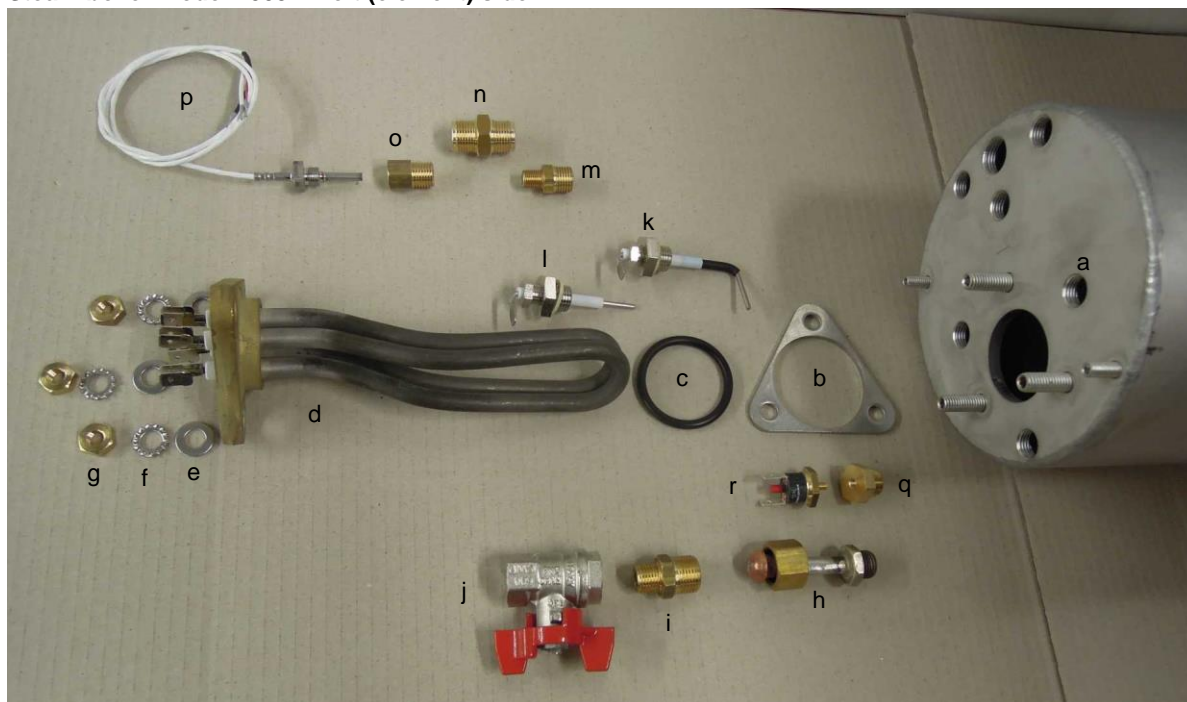

	part number	short description	remark
a	<del>B1001-Sv1</del>	steam boiler, bare; s.st., model 2009	# 030 - ...
b	E1070	triangular O-ring spacer for s.st. boiler 3mm; s.st.	# 141 - ...
c	<del>B1010-v1</del>	O-ring 37.47x5.33mm; Viton	# ... - 174
	B1010-v2	O-ring 39x4.5mm; Viton (gasket for heating element)	# 175 - ...
d		heating element 2x900W	see, page 11
e	C-RS-M8	washer din125A M8; s.st.	
f	C-RT-M8	lock washer din6978A M8; s.st.	
g	G1017	nut M8, 5mm thick; brass	
h	B1057-v1	8mm s.st. tube 3/8M-3/8F (Speedster drain)	
i	S037	fitting 1/4M-3/8M; brass	
j	B076	ball-valve 1/4F-1/4F; nickel plated brass, butterfly handle	# 127 - ...
k	<del>E1006</del>	operational level probe 1/4M (LIV); s.st. bent, with sleeve	replaced by E1029
l	<del>E1007</del>	security level probe 1/4M (SIC); s.st.	replaced by E029
m	S035	fitting 1/8M-1/4M; brass	
n	A009-F	fitting 3/8M-3/8M; brass	
o	B1067	fitting; 1/8F-1/4M; brass	
p	<del>E1005</del>	temperature sensor Pt100 1/8M; 3-wire, 27mm, s.st. (JUMO)	E1005-LV*
nip	E1005-LV	temperature sensor Pt100 1/8M; 2-wire, 27mm (Tasseron)	
q	G1018	plug 1/4M-M4F; brass	
r	E1018-A	overheat safety switch 145°C M4; manual re-set	

\*new sensor E1005-LV is 2-wire and has separate cable..



# Steam boiler model 2009-...: right (heat exchanger) side



	part number	short description	remark
a	<del>B1001-Sv1</del>	steam boiler, bare; s.st., model 2009	#030 - ...
nip	B1001-Sv2	steam boiler, bare; s.st., model 2009 with all s.st. connections	
b	B1012	O-ring 46x2.5mm; Viton (for heat exchanger Speedster)	
c	B1090-v1	heat exchanger Speedster, main body; s.st.	
d	<del>B1006</del>	heat exchanger Speedster, flange; s.st.	see B1006-v2
	B1008	T-fitting 1/4M-1/4M-1/4M; nickel plated brass	
	C-BZ-M6x10	Allen bolt din912 M6x10; s.st.	
	G005	ring M6; copper	
nip	B1006-v2	heat exchanger Speedster, flange with welded-on s.st. T-fitting	replaces VS-B1006 & B1008
e	C-RS-M8	washer din125A M8; s.st.	
f	C-RT-M8	lock washer din6978A M8; s.st.	
g	G1017	nut M8, 5mm thick; brass	
h	S036	fitting 1/4M-1/4M; brass	
i	B1069	fitting 1/4F-3/8M; brass	
nip	B1032	pressure safety valve 1/4M-hose pillar; 3.0 bar, brass	



## Electronic control

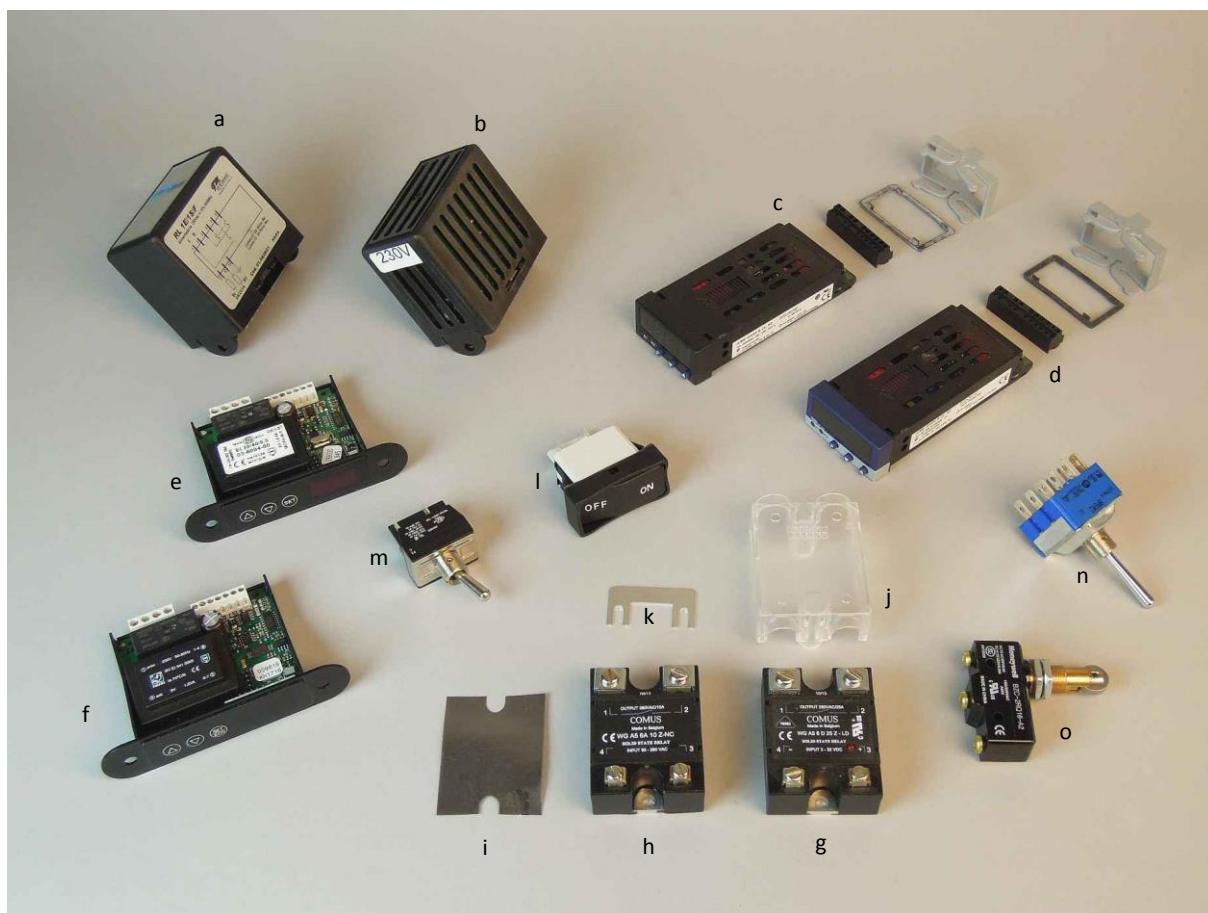

	part number	short description	remark
a	<del>E017-I</del>	level controller 220-230Vac; Gicar	E1017-240A
b	E1017-240A	level controller 220-240Vac; Giemme, with slits in cover	
nip	E1017-110A	level controller 110-120Vac; Giemme, with slits in cover	
c	E1003-iT	temperature controller; Jumo Itron (coffee boiler PID)	# 000 – 248 *
d	E1003-Di	temperature controller; Jumo Di32, (steam boiler thermostat)	# 000 – 175 *
e	out of stock	temperature controller 230Vac; Störk ST25, steam boiler only	red digits, see f
f	out of stock	temperature controller 230 Vac; Störk ST25 (not ECO)	#176/249 - 340
	E1003-ST *	temperature controller 220-240Vac; Störk ST25 ECO	# 341 - .. green digits, used for both coffee and steam
	E1003-SJ *	temperature controller 190-210Vac; Störk ST25 ECO	
	E1003-16 *	temperature controller 110-120Vac; Störk ST25 ECO	
g	E1010-NO	solid state relay NO; 3-32Vdc control voltage (Comus)	
h	E1010-NC	solid state relay NC; 90-240Vac control voltage (Comus)	
i	E008-P	sil-pad for solid state relay (heat transfer sticker)	
j	E009	solid state relay cover; clear plastic	
k	E1009	shorting bridge for SSR; s.st. (3100 ↔ 2200 W conversion)	
l	E1001	rocker switch, double pole, ON-OFF; with mounting material	2001 mains switch
m	E2001-T	toggle switch, double pole, ON-OFF; with mounting material	2014 mains switch
n	E1027	toggle switch, triple pole, ON-OFF-ON; with mounting material	hot water switch
o	E1015	plunger switch with wheel (used on Speedster brew lever)	Honeywell
*	specify: Speedster machine number; °C or °F		





## Waterways right hand side: manifold

brass flange valves have been replaced with stainless steel flange valves (05-2015)  
 restrictor in block has been replaced with flat-jet on block (2017).

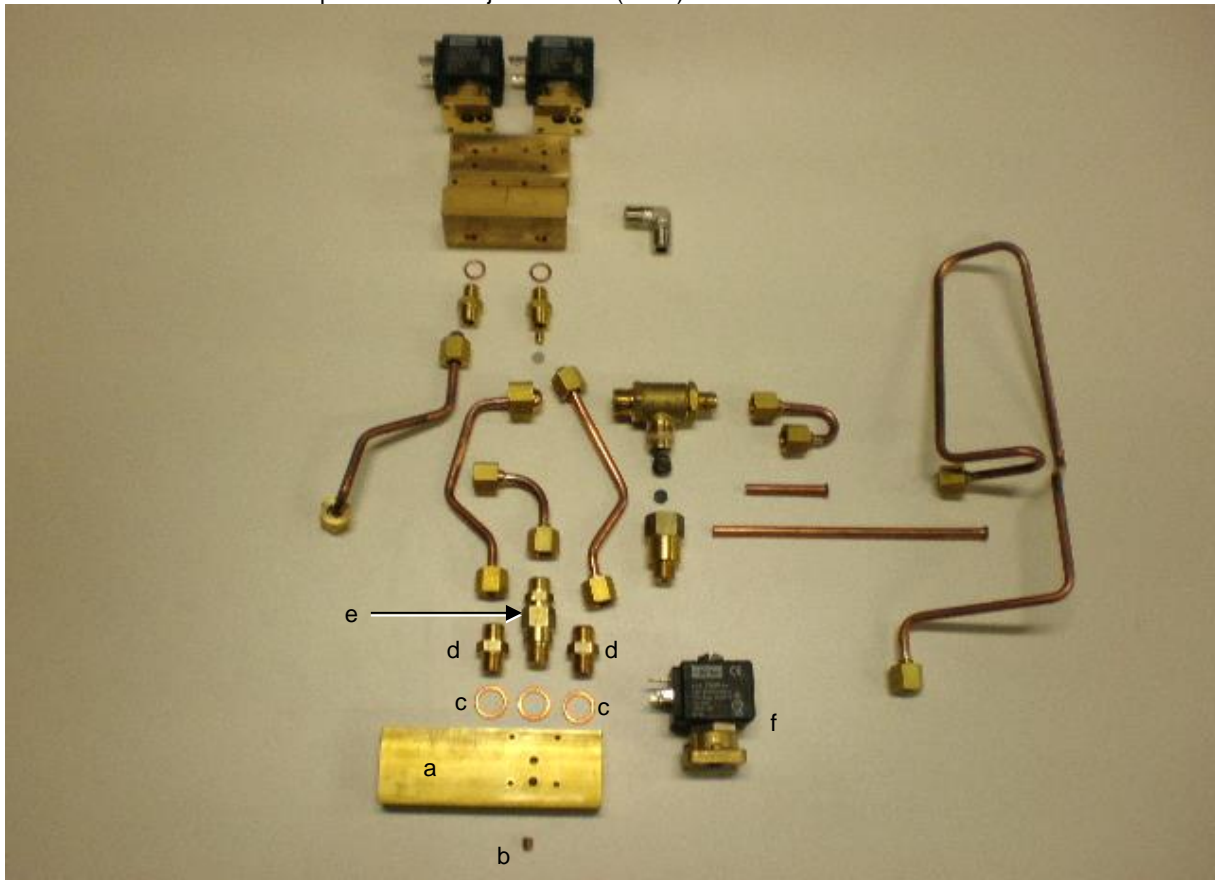

	part number	short description	remark
nip	B1100-C	manifold assembly Speedster; 230V, jet M6x6 0.8mm	see next
nip	B1100-Cv2	manifold assembly Speedster; 230V, flat-jet 0.8mm	s.st. valves
	B1100-11Cv2	manifold assembly Speedster; 115V, flat-jet 0.8mm	s.st. valves
a	B1100	manifold Speedster bare; brass (for jet M6x6)	
nip	B1100-v2	manifold Speedster bare; brass (for flat-jet)	
b	B034-08	jet M6x6 orifice 0.8mm; s.st.	
nip	B6003-08	flat-jet for block 0.8mm; s.st.	
nip	B6003-O	O-ring 6.07x1.78mm; Viton	for flat-jet
c	B079	ring 1/4"; copper	
d	S036	fitting 1/4M-1/4M; brass	
e	B1003	one-way valve 1/4M-1/4M; brass	
f	<del>E026-230</del>	2-way flange valve, orifice 2.5mm; brass, coil 230Vac (Parker)	E6026-23S
	<del>E026-110</del>	2-way flange valve, orifice 2.5mm; brass, coil 115Vac (Parker)	E6026-11S
nip	C-SK-M4x12	Phillips screw din7985 M4x12; s.st.	for brass valves
nip	C-RT-M4	lock washer din6798A M4; s.st.	
nip	E6026-23S	2-way flange valve, orifice 2.5mm; s.st., coil 230Vac (Parker)	minimum 216Vac
	E6026-11S	2-way flange valve, orifice 2.5mm; s.st., coil 115Vac (Parker)	
	C-SK-M4x08	Phillips screw din7985 M4x8; s.st.	s.st. valve / flat-jet





## Waterways right hand side: mix-block

brass flange valves have been replaced with stainless steel flange valves (05-2015)  
 restrictor in fitting has been replaced with flat-jet on block (2017).

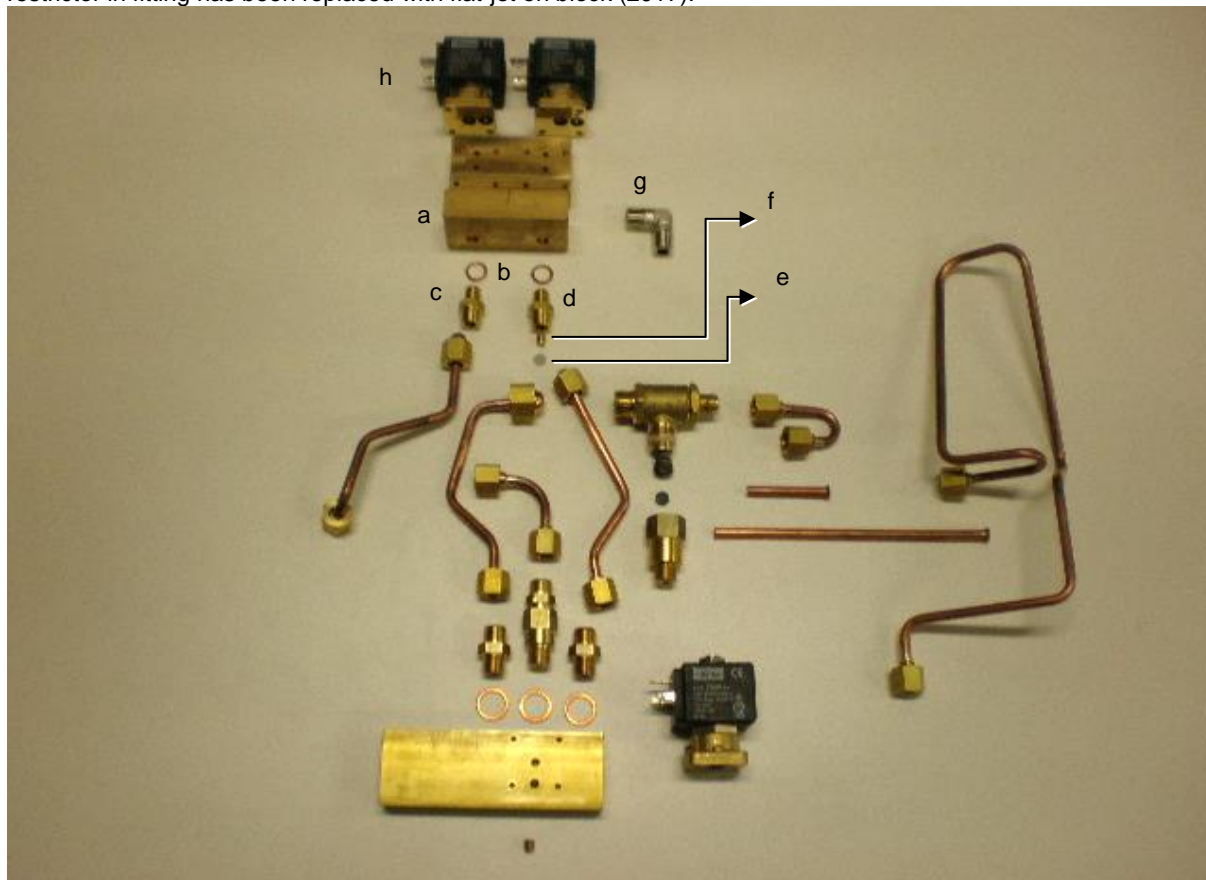

	part number	short description	remark
nip	B1018-C	mix-block Speedster assembly; 230V, s.st. valves	see next
nip	B1018-Cv2	mix-block Speedster assembly; 230V, s.st. valves, flat-jet	w. flat-jet 1.0mm
	B1018-11Cv2	mix-block Speedster assembly; 115V, s.st. valves, flat-jet	w. flat-jet 1.0mm
a	B1018	mix-block Speedster bare; brass	
b	B082	ring 1/8"; copper	
c	S035	fitting 1/8M-1/4M; brass	
d	B035-B	jet housing 1/8M-1/4M; brass, with M6 inside thread	with flat-jet on block d..f are replaced by S035
e	B036-B	perforated screen for jet housing; s.st.	
f	B034-09	jet M6x6 orifice 0.9mm; s.st.	
nip	B6003-08	flat-jet for block 0.8mm; s.st.	
nip	B6003-O	O-ring 6.07x1.78mm; Viton	for flat-jet for block
g	S038	knee-fitting 1/4M-1/4M; nickel plated brass	
h	<del>E026-230</del>	2-way flange valve, orifice 2.5mm; brass, coil 230Vac (Parker)	E6026-23S
	<del>E026-110</del>	2-way flange valve, orifice 2.5mm; brass, coil 115Vac (Parker)	E6026-11S
nip	C-SK-M4x12	Phillips screw din7985 M4x12; s.st.	for brass valves
nip	C-RT-M4	lock washer din6798A M4; s.st.	
nip	E6026-23S	2-way flange valve, orifice 2.5mm; s.st., coil 230Vac (Parker)	minimum 216Vac
	E6026-11S	2-way flange valve, orifice 2.5mm; s.st., coil 115Vac (Parker)	
	C-SK-M4x06	Phillips screw din7985 M4x6; s.st.	for s.st. valves



## Waterways right hand side, water-lines

in-group restrictor has been re-located to in-line restrictor in B1050 (#115, 04-2011)

in-line restrictor is replaced by flat-jet at group-valve (#660, 02-2017, empty B034), eventually re-initiating the use of B1050

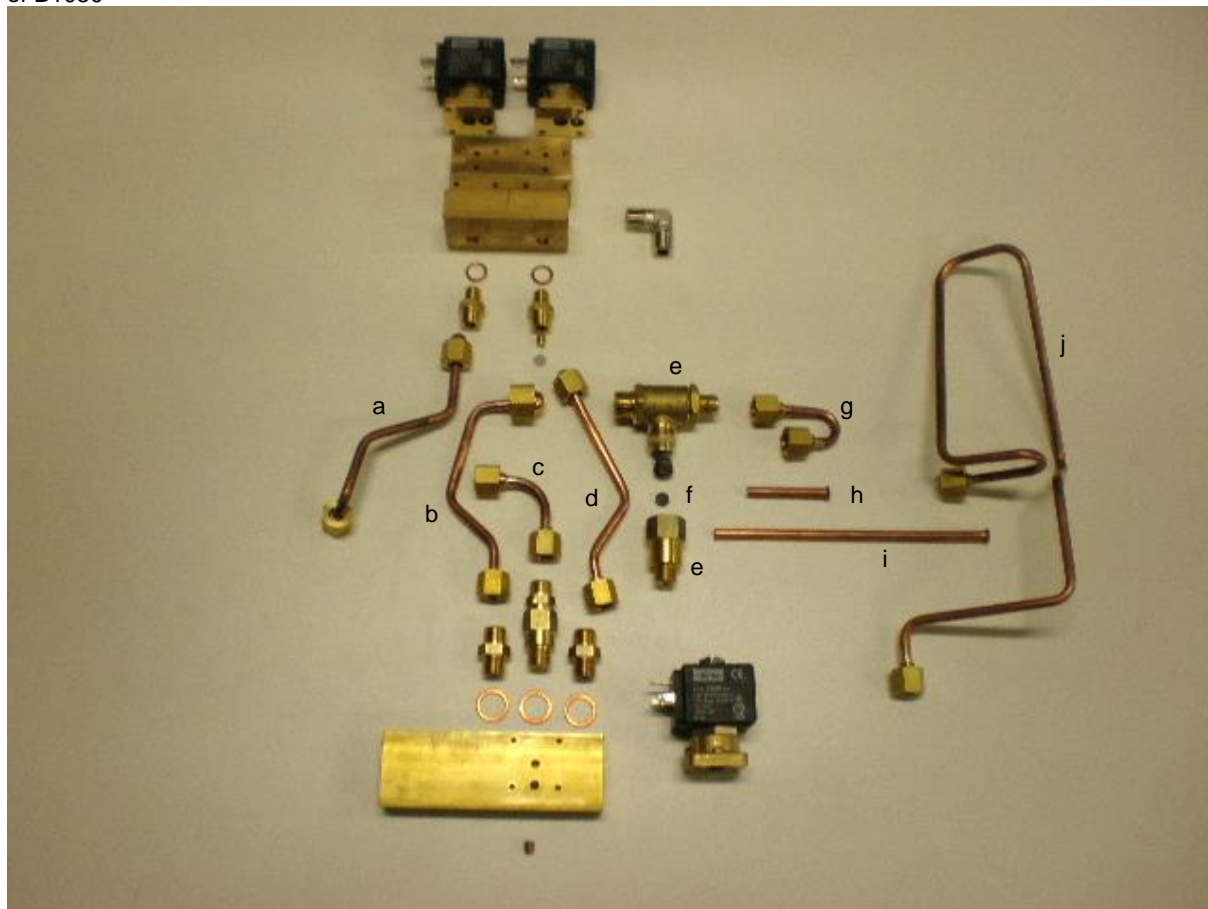

	part number	short description	remark
a	B1054	6mm copper tube; steam boiler ↔ mix block	
b	B1047	6mm copper tube; manifold ↔ combi valve	
c	B1052	6mm copper tube; manifold ↔ steam boiler	
d	B1053	6mm copper tube; manifold ↔ mix block	
e	B101-IC	combi valve (one-way/expansion); brass (Mirdro & Speedster)	includes f
f	B101-ISC	disk 8x3mm; Viton (seal on plunger combi-valve)	
g	B1048	6mm copper tube; combi-valve ↔ HX	
h	B1049	6mm copper tube; flared injection line in HX (47mm)	
i	B1049-v2	6mm copper tube; flared injection line in HX (140mm)	
j	B1050	6mm copper tube; HX ↔ coffee boiler (1-piece)	*
nip	B1050-A	6mm copper tube; HX ↔ static jet	replaces XS-B1050
	B035-C06	jet in housing assembly; M6x6, orifice 0.6mm	remove
	B1050-B	6mm copper tube; static jet ↔ coffee boiler	in-group jet!
*	The 1-piece line B1050 was used in combination with an in-group jet. It can also be used in combination with a flat-jet underneath the group-valve. Note that there should be only 1 jet within the coffee-system.		
nip	B1045	2mm copper tube; coffee boiler ↔ pressure gauge	



## Front-panel mounted items

gauges, PPIC, hot water switch

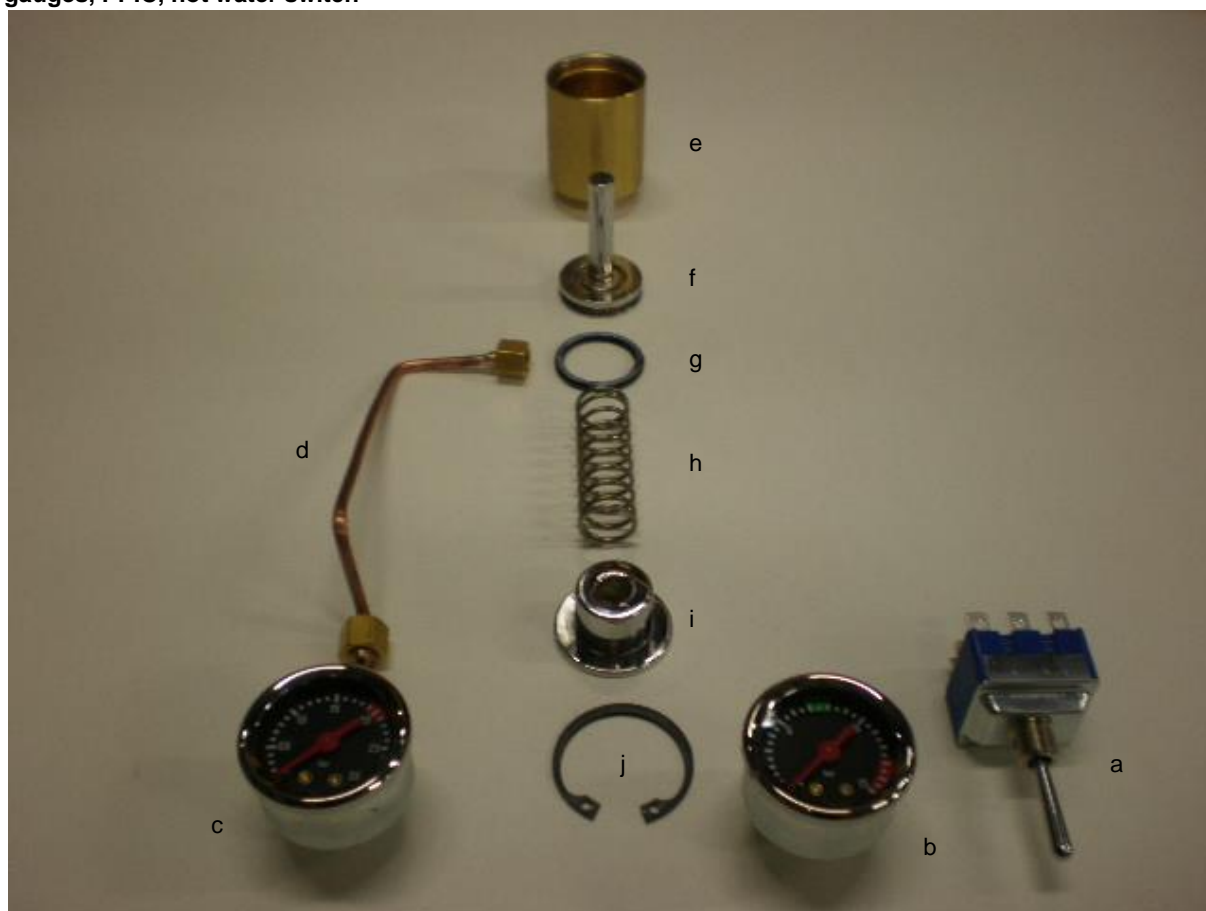

	part number	short description	remark
a	E1027	toggle switch, triple pole, ON-OFF-ON; with mounting material	hot water switch
b	<del>B1031-P</del>	pressure gauge 15 bar (for coffee boiler)	# 000 - 402
	B1031-PK	pressure gauge 15 bar; KvdW marking	# 402 - ...
c	<del>B1031-S</del>	pressure gauge 3 bar (for steam boiler)	# 000 - 402
	B1031-SK	pressure gauge 3 bar; KvdW marking	# 402 - ...
nip	F1020-S	mounting bracket for pressure gauge B1031-...; s.st.	
nip	F065	flat nut 1/8"; brass	to mount gauge
d	<del>B1044</del>	4mm copper tube; steam boiler (front) ↔ pressure gauge	# 000 - 312
nip	B1044-v1	4mm copper tube; steam boiler (back) ↔ pressure gauge	# 312 - ...
e	cannot be ordered as separate parts	progressive pre-infusion cylinder Speedster, bare; brass	complete: B1004 see page 21
f		progressive pre-infusion piston Speedster; s.st.	
i		PPIC-cover Speedster; polished s.st.	
g		O-ring 26.57x3.53mm; Viton (for Speedster PPIC piston)	
h	B1004-V	spring; s.st. (for Speedster PPIC-piston, appr. 1,8x20x65mm)	
j	C-VA-M37	circlip din472 M37 (for Speedster PPIC)	



## Progressive pre-infusion cylinder



	part number	short description	remark
a	C-SM-M5x60-P	metal screw din964 M5x60; s.st, polished head	
b	C1008-PP	front plate for Speedster PPIC; s.st., polished	
c	out of stock	front plate for Speedster PPIC; s.st., matte-black	
d	B1004	progressive pre-infusion cylinder assembly Speedster (PPIC)	see page 20
e	C1008-B	mounting bracket for Speedster PPIC; s.st.	



## Shot timer – first model

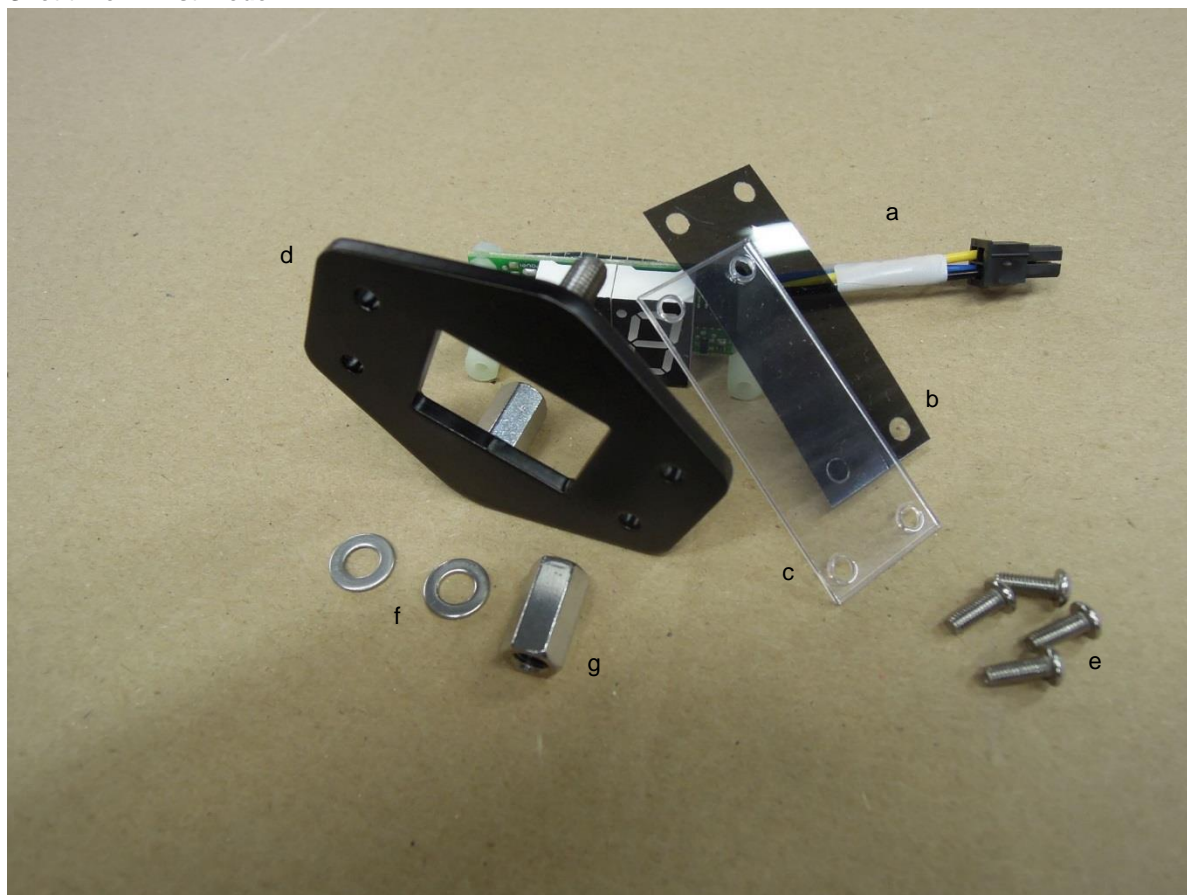

	part number	short description	remark
a	E6080	shot timer display with 4-pole Molex plug	# 346 - ...
b	<del>E6080-F</del>	shot timer filter; green/grey	E6080-N
c	<del>E6080-P</del>	shot timer window; clear plastic	see page 23
d	out of stock	shot timer front plate; s.st., matte black	C2008-TP see page 23
e	C-BI-M3x08	Allen screw iso7380 M3x8; s.st.	for b+c
f		washer din125A M5; s.st.	not used
g	C-MV-M5x15	connection nut din6334 M5 (H=3D); s.st.	





## Shot timer display, PCB, and mounting material

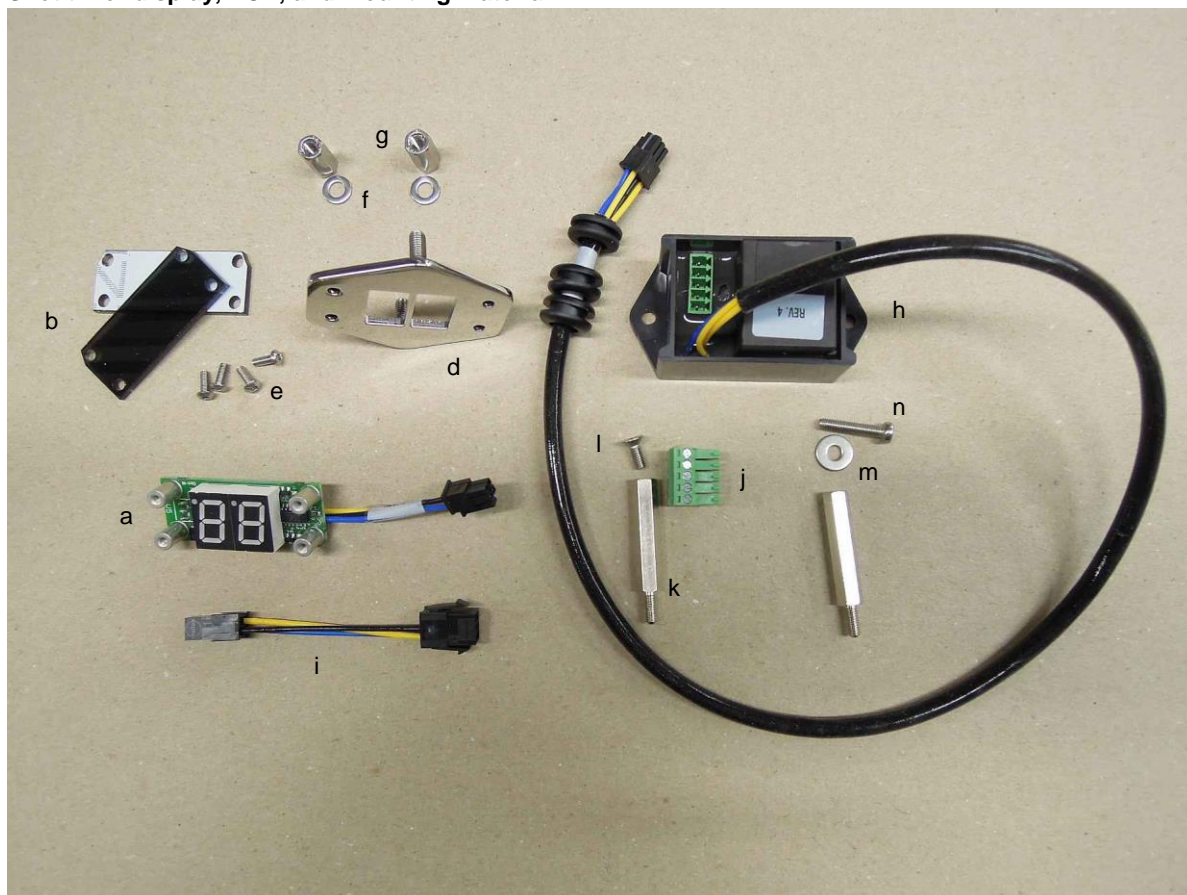

	part number	short description	remark
a	E6080	shot timer display with 4-pole Molex plug	# 346 - ...
b	E6080-N	shot timer window; 3mm thick grey plastic	
d	C2008-TP	shot timer front plate with digit separator; s.st. polished	
e	C-BI-M3x10	Allen screw iso7380 M3x10; s.st.	for E6080-N
f		washer din125A M5; s.st., not used	not used
g	C-MV-M5x15	connection nut din6334 M5 (H=3D); s.st.	
h	E081-2	shot timer combi-PCB 220-240Vac; 6-pole Molex plug	
nip	E2081-1	shot timer combi-PCB 110-120Vac; 6-pole Molex plug	
i	E2083	shot timer converter-cable; 6- to 4-pole Molex	
j	E6064-5	terminal plug 5 pin; green	
k	C-AH-M4x35	standoff pillar 7x35 M4female-M4male; nickel plated brass	
l	C-SV-M4x10	Phillips screw din965 M4x10; s.st.	
m	C-RS-M4	washer din125A M4; s.st.	
n	C-SG-M4x20	machine screw din84 M4x20; s.st.	



## Steam valve and wand

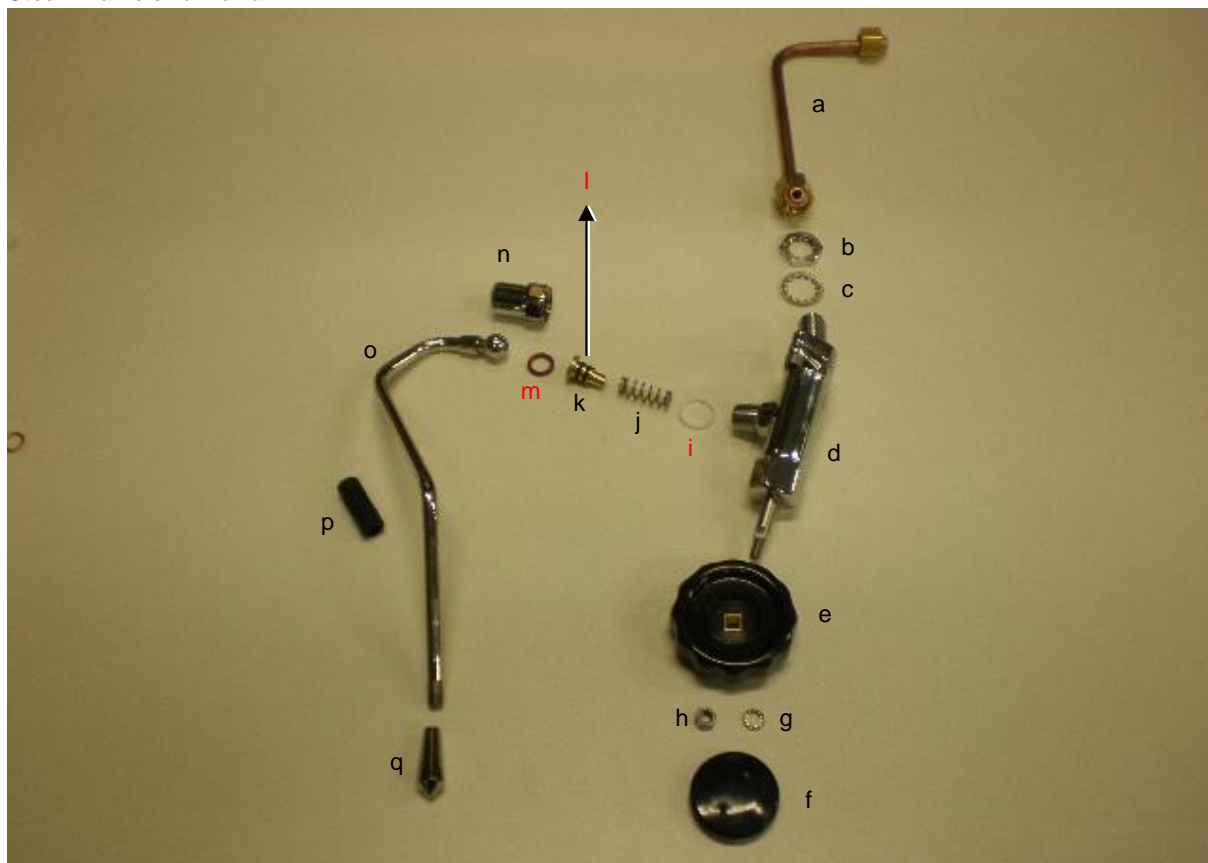

	part number	short description	remark
a	B1043	8mm copper tube; steam boiler ↔ steam valve	
b		flat nut 3/8; chromed brass	part of S001-STC
c	C-RO-M16	lock washer din6797J M16; s.st.	
d	S001-STC	steam valve; chromed brass, with lock washer and nut	
e..h	<del>S002</del>	valve knob; black plastic, with mounting materials	replaced by next
nip	S002-v2	steam valve knob; Bakelite, custom (tulip model)	replaces e..h
	C-RC-M6	fender washer din9021 M6; s.st.	
	C-MZ-M6	lock nut din986 M6; s.st., dome cap	
i	S014-R	ring 3/8"; Teflon (21x16.8x2 mm)	
j	S011-SP	spring; s.st. (against trumpet plunger, appr. 1.5x8x30mm)	
k	S012-ST	trumpet plunger; brass, complete with two O-rings	
l	S011-ST	O-ring 7.2x1.9 mm; EPDM, on brass trumpet plunger	2 are needed
m	S013	O-ring (appr. 10.5x2.7mm); red silicone	
n	<del>S014</del>	ball-joint nut 22mm; chromed brass	S014-B
nip	S014-B	ball-joint nut 22mm; chromed bronze	
o	S1021	steam wand Speedster; polished s.st.	
p	S031	anti-burn sleeve on steam/water wand	
q	S1016-12	steam wand tip 4x1.2mm; s.st.	
nip	S045-SK	service kit steam/hot water wand (2x S011-ST + S013 + S014-R)	<b>l (x2) + i + m</b>



## Hot water valve and wand

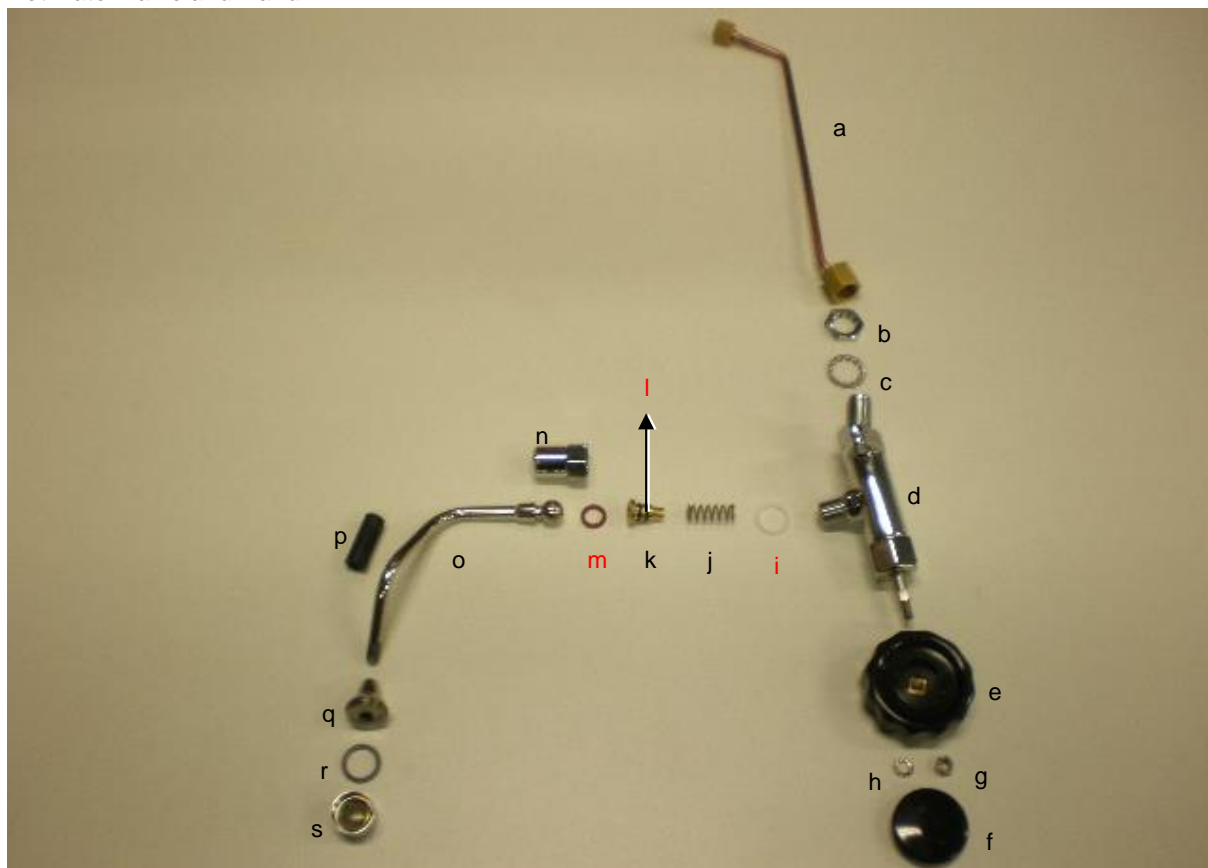

	part number	short description	remark
a	B1055	6mm copper tube; mix-block ↔ hot water valve	
b		flat nut 3/8; chromed brass	part of S001-THC
c	C-RO-M16	lock washer din6797J M16; s.st.	
d	S1001-THC	hot water valve; chromed brass	modified steam valve
e..h	<del>S002</del>	valve knob; black plastic, with mounting materials	replaced by next
nip	S002-v2	steam valve knob; Bakelite, custom (tulip model)	replaces e..h
	C-RC-M6	fender washer din9021 M6; s.st.	
	C-MZ-M6	lock nut din986 M6; s.st., dome cap	
i	S014-R	ring 3/8"; Teflon (21x16.8x2 mm)	
j	S011-SP	spring; s.st. (against trumpet plunger, appr. 1.5x8x30mm)	
k	S012-ST	trumpet plunger; brass, complete with two O-rings	
l	S011-ST	O-ring 7.2x1.9 mm; EPDM, on brass trumpet plunger	
m	S013	O-ring (appr. 10.5x2.7mm); red silicone	
n	<del>S014</del>	ball-joint nut 22mm; chromed brass	S014-B
nip	S014-B	ball-joint nut 22mm; chromed bronze	
o	S1022	hot water wand Speedster; polished s.st.	
p	S031	anti-burn sleeve on steam/water wand	
q	S018	hot water wand tip; s.st. (mushroom shape)	
r	S020-R	O-ring (appr. 16.5x2.7mm); EPDM (hot water screen assy)	
s	S020	screen assembly on hot water wand tip; chrome plated brass	
nip	S045-SK	service kit steam/hot water wand (2x S011-ST + S013 + S014-R)	<b>l (x2) + i + m</b>



### Steam and hot water valve

Metal ball and small spring -marked X- are removed in both valves.

Parts marked S are not present in hot water valve

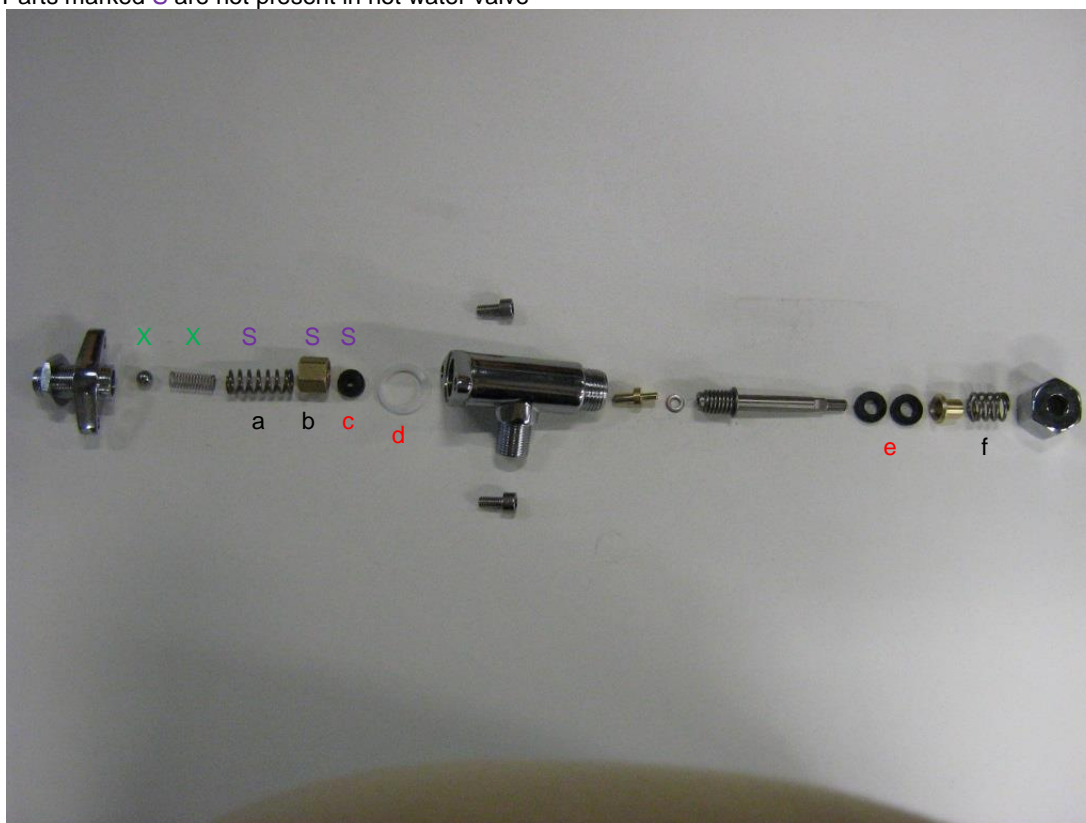

Not all parts are sold separately.

	part number	short description	remark
a	F122	spring; s.st. (appr. 2x9x31mm)	at steam plunger
b	S024-C	plunger in steam valve; brass, with Viton sealing disk	
c	S023	sealing disk 13x4x4 mm; Viton (on steam valve plunger)	
d	S021	ring 24x18x2mm; Teflon (between steam valve body and base)	
e	S025-R	ring 15.5x7.5x5x4mm (seal on steam valve shaft)	2 are needed
f	F126	spring; s.st. (appr. 2x12x17mm)	in end-cap
nip	S044-SK	service kit steam valve (S021 + S023 + 2x S025-R)	c + d + e (2x)



## Brew lever

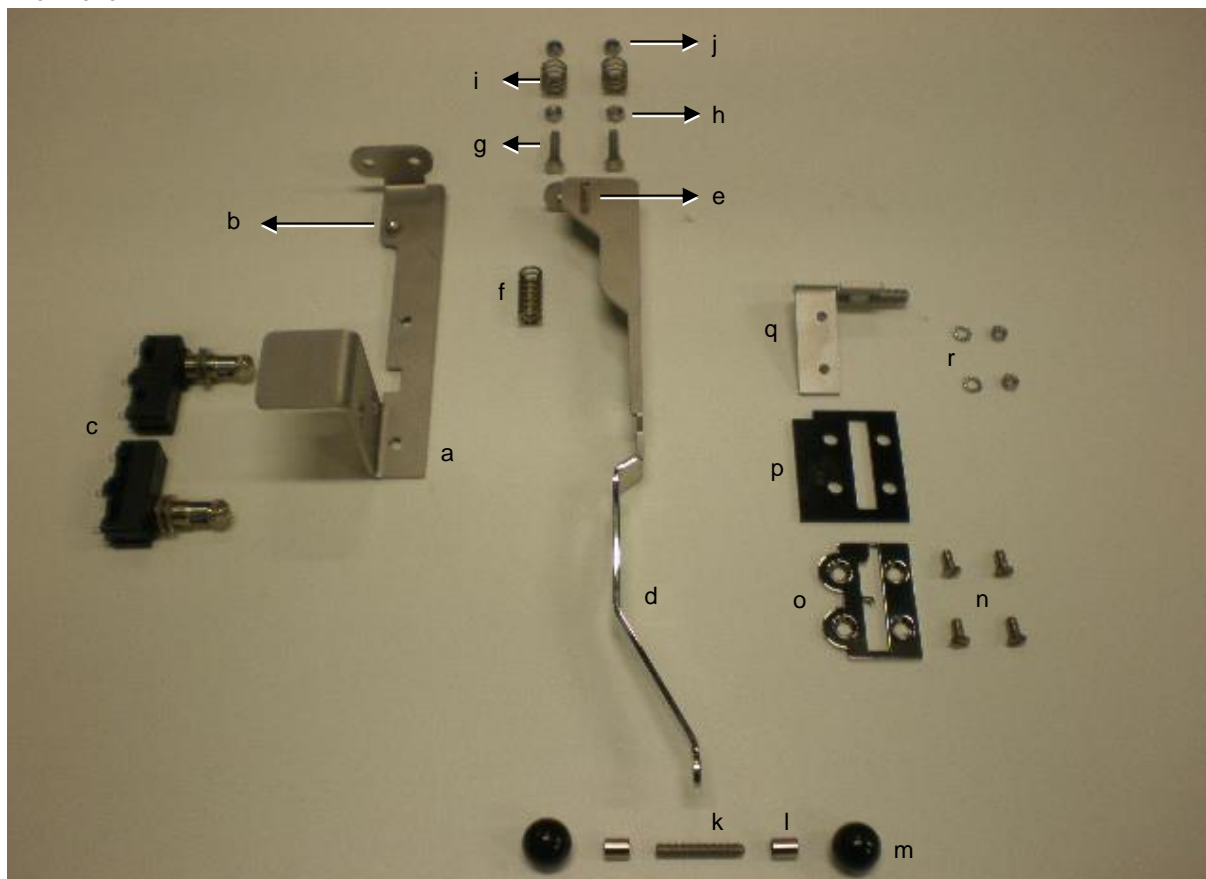

	part number	short description	remark
a	F1120	support for lever and switches Speedster; sand blasted s.st.	
b	C-BZ-M5x06	Allen bolt din912 M5x6; s.st.	
c	E1015	plunger switch with wheel (used on Speedster brew lever)	Honeywell
d	F1121	brew lever Speedster; partly polished s.st.	
e	F1123	adjusting screw M5 for spring; s.st., length 20mm	
f	F122	spring; s.st. (appr. 2x9x31mm)	
g	C-BT-M6x25	bolt din933 M6x25; s.st.	
h	C-MH-M6	nut din934 M6; s.st.	
i	F126	spring; s.st. (appr. 2x12x17mm)	
j	C-MB-M6	lock nut din985 M6; s.st.	
k	C-SS-M6x50	set screw din916 M6x50; s.st.	replaced by next
l	<del>F1080-G</del>	tubular spacer; polished s.st.	
m	<del>F1080-HZ</del>	lever knob, ball-shape, M6F; black plastic	
nip	C-SS-M6x35	set screw din916 M6x35; s.st.	replaces k...m
nip	F1081-HZ	lever knob, elongated-ball shape, M6F; black plastic	
n	C-SM-M5x12-P	metal screw din964 M5x12; s.st., polished head	
o	out of stock	brew lever guide plate; polished s.st., 4 holes (2009 – # 327)	see F1124
nip	F1124	brew lever guide plate; polished s.st., 2 holes, 2 bolts (2014)	# 333 - ...
p	F1090	brew lever guide Speedster; black POM	
q	F1009-Rv1	right side panel bracket with bolt; sand blasted s.st.	# 030 - ...
r	C-RT-M5 C-MH-M5	lock washer din6798A M5; s.st. nut din934 M5; s.st.	





## Discharge, model 2014

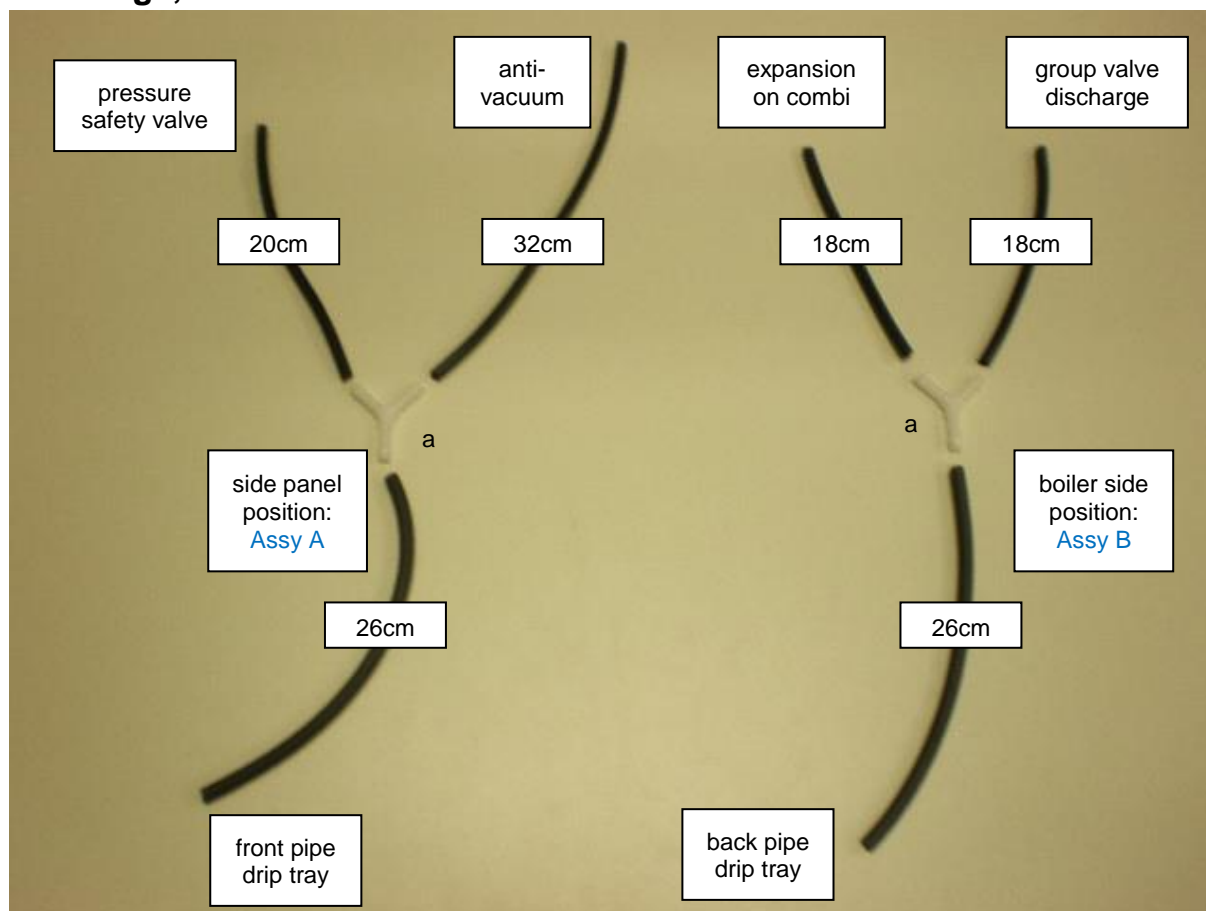

	part number	short description	remark
a	B1066	Y-shape hose connector 6mm; white POM	
assyA	B1066-A	drain hose assembly of 3 hoses and 1 connector; a-symmetric	
assyB	B1066-B	drain hose assembly of 3 hoses and 1 connector; symmetric	
	C-HS-ZZ4x8	silicone hose 4x8mm; black, per meter	specify length



## Frame and panel-work

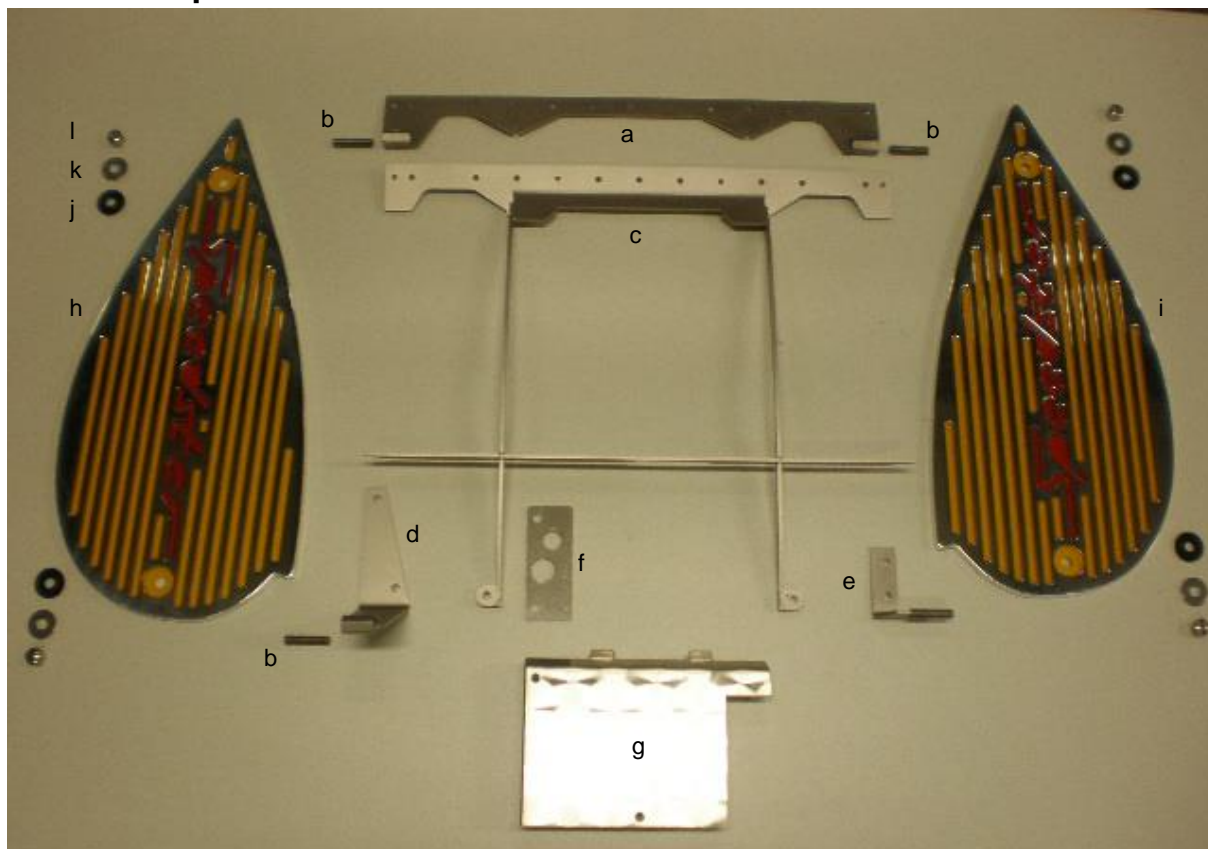

	part number	short description	remark
nip	<del>F1007</del>	horizontal strip with bolts; sand blasted s.st.	# 000 - 029
a	F1007-v1	horizontal strip with nuts; sand blasted s.st.	# 030 - ...*
	F1007-Pv1	horizontal strip with nuts; sand blasted s.st., polished rim	# 030 - ...**
b	C-SS-M8x35	set screw din916 M8x35; s.st.	
nip	<del>F1018</del>	top panel frame; sand blasted s.st.	# 000 - 029
c	F1018-v1	top panel frame; sand blasted s.st.	# 030 - ...*
	F1018-Zv1	top panel frame; sand blasted s.st., polished rim	# 030 - ...**
nip	<del>F1008-L</del>	left side panel bracket with bolt; sand blasted s.st.	# 000 - 029
d	F1008-Lv1	left side panel bracket with nut, sand blasted s.st.	# 030 - ...
e	<del>F1009-R</del>	right side panel bracket with bolt; sand blasted s.st.	# 000 - 029
	F1009-Rv1	right side panel bracket with bolt; sand blasted s.st.	# 030 - ...
f	no longer available	support plate for cable strain relief, model 2008; sb s.st.	
	F1110	support plate for cable strain relief, model 2014; sb s.st.	fits all?
g	<del>C1005</del>	electrics cover Speedster, model 2008; s.st.	# 000 - 347
	C2005	electrics cover Speedster, model 2014; s.st.	# 348 - ...
h	C1009-... ..	side panel LEFT; aluminium, number to be completed	***
i	C1010-... ..	side panel RIGHT; aluminium, number to be completed	***
j	F030	fender washer 8x24x2mm; black rubber	C-RC-M8
k	C-RC-M8	washer 25x8.4x2.5mm; black PVC	
l	C-MD-M8-P	cap nut din917 M8; s.st., polished	

\* engine turned and mirror body

\*\* black (or other color) body

\*\*\* add GR for yellow/red; ZZ for black/black; ZR for black/red; contact us for custom colours.



## Cup warming tray

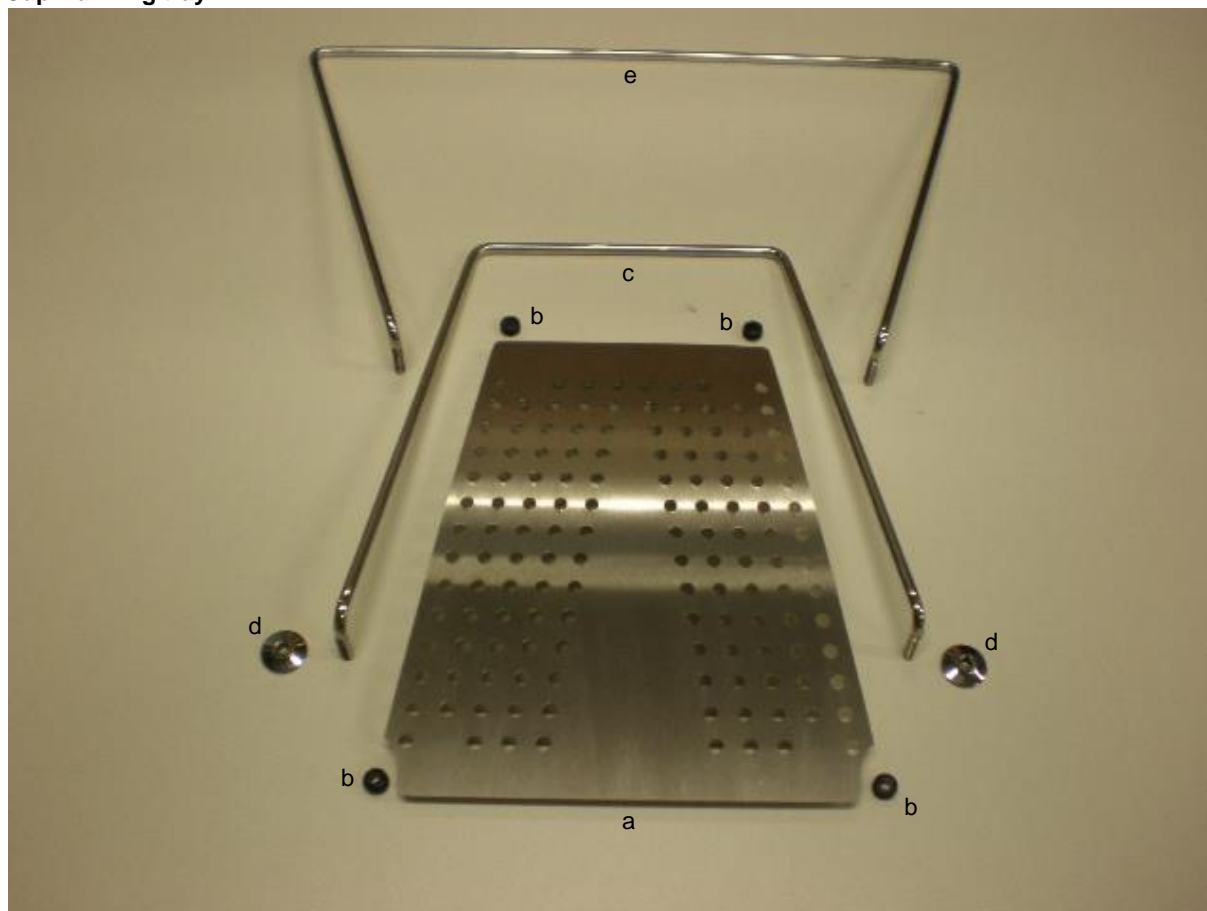

	part number	short description	remark
a	F1022-S	cup warming tray Speedster; brushed finish s.st.	
b	C-DT-5x11x1,5	grommet A=5, D=1.5; black PVC	
c	F1024-S	rail for cup warming tray; polished s.st., standard	
d	<b>F1020</b>	support collar M6; polished s.st.	
e	not available	rail for cup warming tray; polished s.st., wide	



## Drip tray, steam boiler isolation

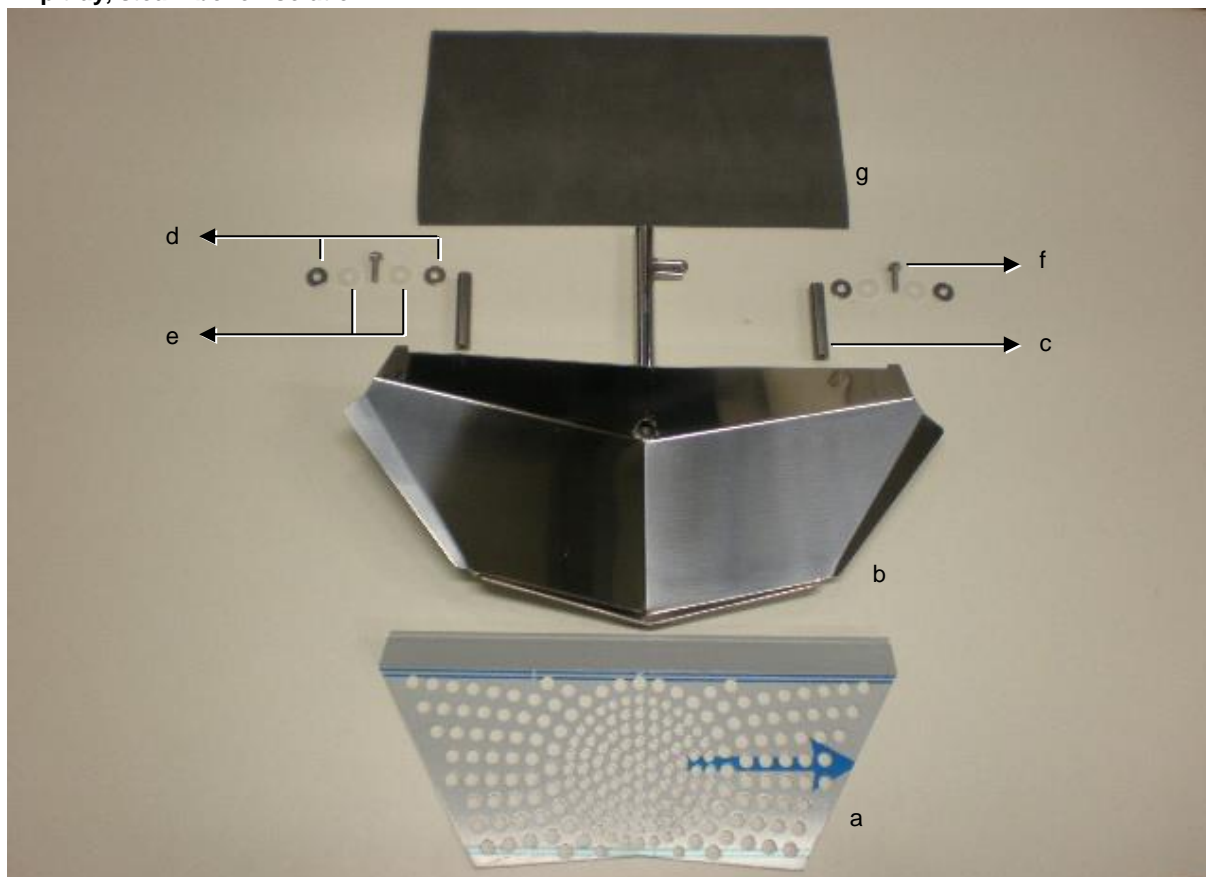

	part number	short description	remark
a		drip tray grill Speedster; s.st. (shown with protective foil)	replaced by next
nip	F1012-S	drip tray grill Speedster; s.st., with small cut-outs on sides	
b	F1010-S	drip tray Speedster; s.st.	
c	F007	drip tray support rod, 65mm, M6F-M6F; s.st.	
d	C-RC-M6	fender washer din9021 M6; s.st.	
e	C-RN-6x18x2	fender washer 6x18x2mm; natural nylon	
f	C-BT-M6x20	bolt din933 M6x20; s.st.	
g	B1070	steam boiler isolation; grey silicone foam	
nip	out of stock	heat shield steam boiler, high model; s.st.	
nip	out of stock	heat shield steam boiler, low model s.st., screw attachment	fits older
nip	C1004	heat shield steam boiler, low model; s.st., pinch attachment	fits older





## Front and bottom panel

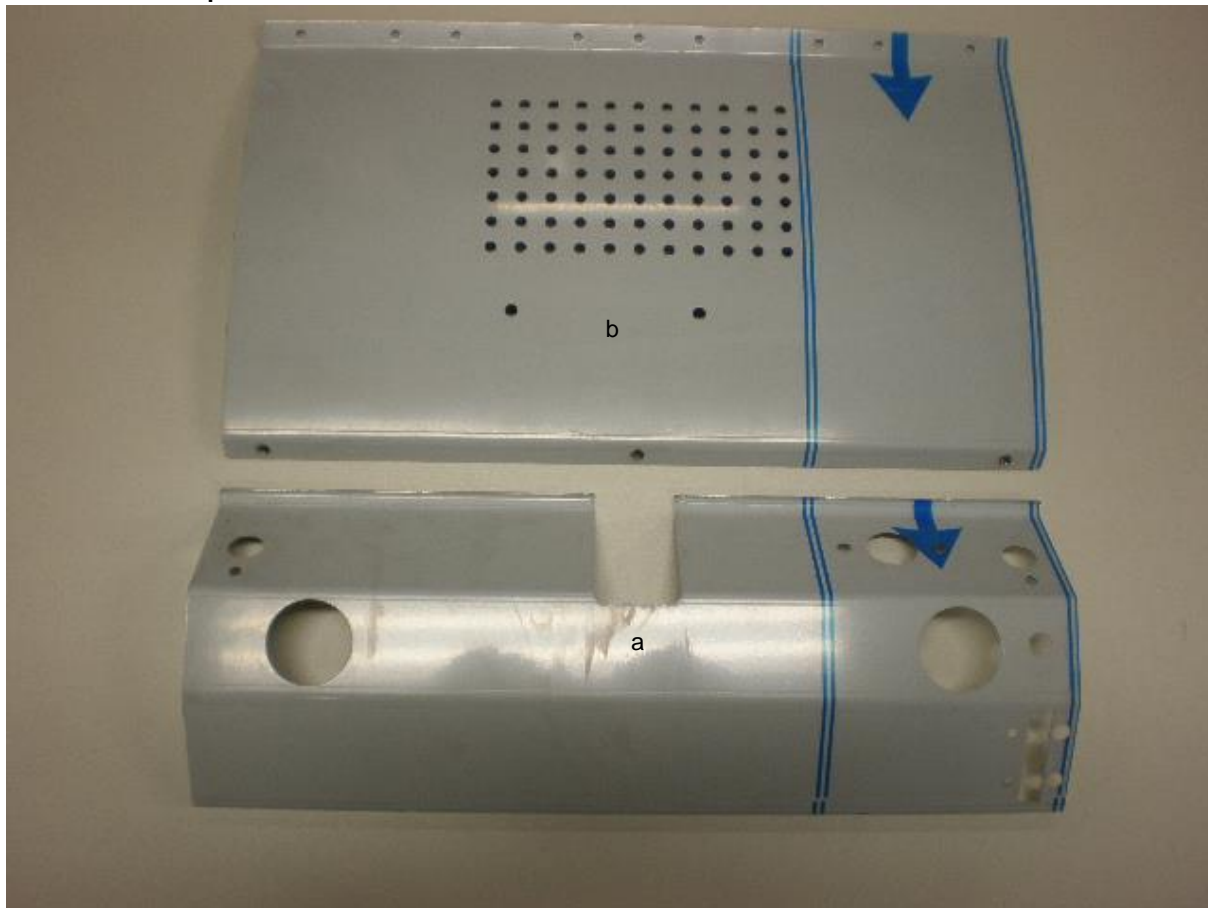

Panel-work has changed a few times since production of the Speedster started. Major changes for the front panel are to allow for the wider group neck and later to accommodate the shot-timer display. The bottom panel has gained perforations for better air-flow around the machines' electronics. Newer parts may or may not fit on older machines.

Apart from these changes in shape, panel-work has been mounted with a variety of finishes: engine turned, mirror-8, mirror, matte-black, crackle-black and custom color.

**When in need of new panel work, contact us to discuss the possibilities of replacement.**

	Part	remark
a	front panel; s.st. (shown is model 2008, with protective foil)	contact us
b	bottom panel; s.st. (shown is model 2008, with protective foil)	contact us



## Top panel

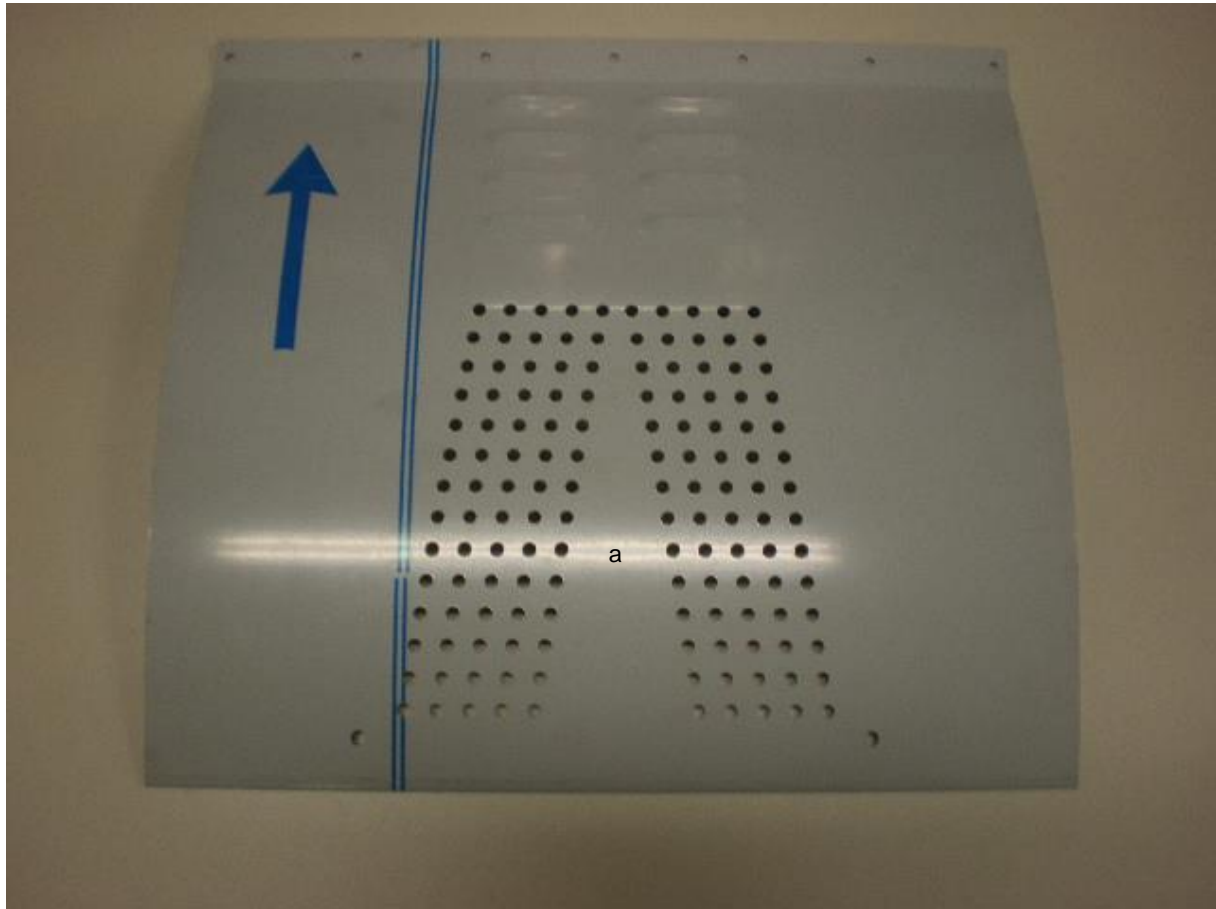

	Part	remark
a	top panel; st.st. (shown is model 2008 with protective foil)	contact us



## Pump, portafilter, etc.

For parts that can be found on all our machines:

1. Pump, pump motors, water and discharge hoses:  
[www.keesvanderwesten.com/downloads/pumpsandhoses.pdf](http://www.keesvanderwesten.com/downloads/pumpsandhoses.pdf)
2. Portafilters and filter baskets:  
[www.keesvanderwesten.com/downloads/portafilters.pdf](http://www.keesvanderwesten.com/downloads/portafilters.pdf)

click the link above or copy-paste the address into your browser.

